

The "-3" in the Model
Number indicates 115/230
Volt, 60 Cycle.

*
* PARTS LIST *
* SPL 32E *

SIZE: 12,000 Watts
DRIVE: PTO
TYPE: Two Pole

MODEL:	12XXPTO-3/B 12XXPTOC-3/B	15IXXPTO-3/B 15IXXPTOC-3/B	15LXXPTOC-3/C
Armature 115/230 Volt	46922-1	46922-1	46922-1
Bearing, Comm. End	46911	46911	46911
Bearing, Retaining Ring (Comm. End)	21549	21549	21549
Bearing, Drive End	46913	46913	46913
Bearing Retainer Plate	44318	44318	44318
Oil Seal	46912	46912	46912
Spacer	20137	20137	20137
Field Coil	47072	46923	46923
Field Coil	47072-1	46923-1	46923-1
Field Shell & Bracket	44331	44331	44331
Armature Nut (Fan End)	9549	9549	9549
Armature Flat Washer (Fan End)	21867	21867	21867
Armature Lockwasher (Fan End)	20039	20039	20039
End Bracket (Drive End)	43850	43850	43850
Fan	23404	23404	23404
Fan Lockwasher	40552	40552	40552
End Cover	23634	23634	23634
End Cover Screw	4637	4637	4637
D. C. Brush Rack (Riveted)	44347 &-1	44347 &-1	44347 &-1
Brush Holder & Rack Assembly	44346 &-1	44346 &-1	44346 &-1
A. C. Brush Holder (16)	23500-2	23500-2	23500-2
A. C. Brush (16)	24981	24981	24981
D. C. Brush (2)	41393	41393	41393
D. C. Condenser	41180	41180	41180
A. C. Condenser (2)	41221	41221	41221
Voltmeter	22300	22300	22300
Circuit Breaker	44382*	44382*	- - -
Switch (MAXI-WATT)	- - -	44022	44022
Base Assembly	24723	24723	23723
Receptacle (115 V. Duplex)	- - -	- - -	24749
Receptacle (230 V. 50 Amp.)	- - -	- - -	48343
Fuse Base	- - -	- - -	48406
Fuse	- - -	- - -	48469
Element only for Fuse	- - -	- - -	48469-1

*Not used on Models
12XXPTO-3/B & 15IXXPTO-3/B

For Parts List of Gear Case See SPL 32F

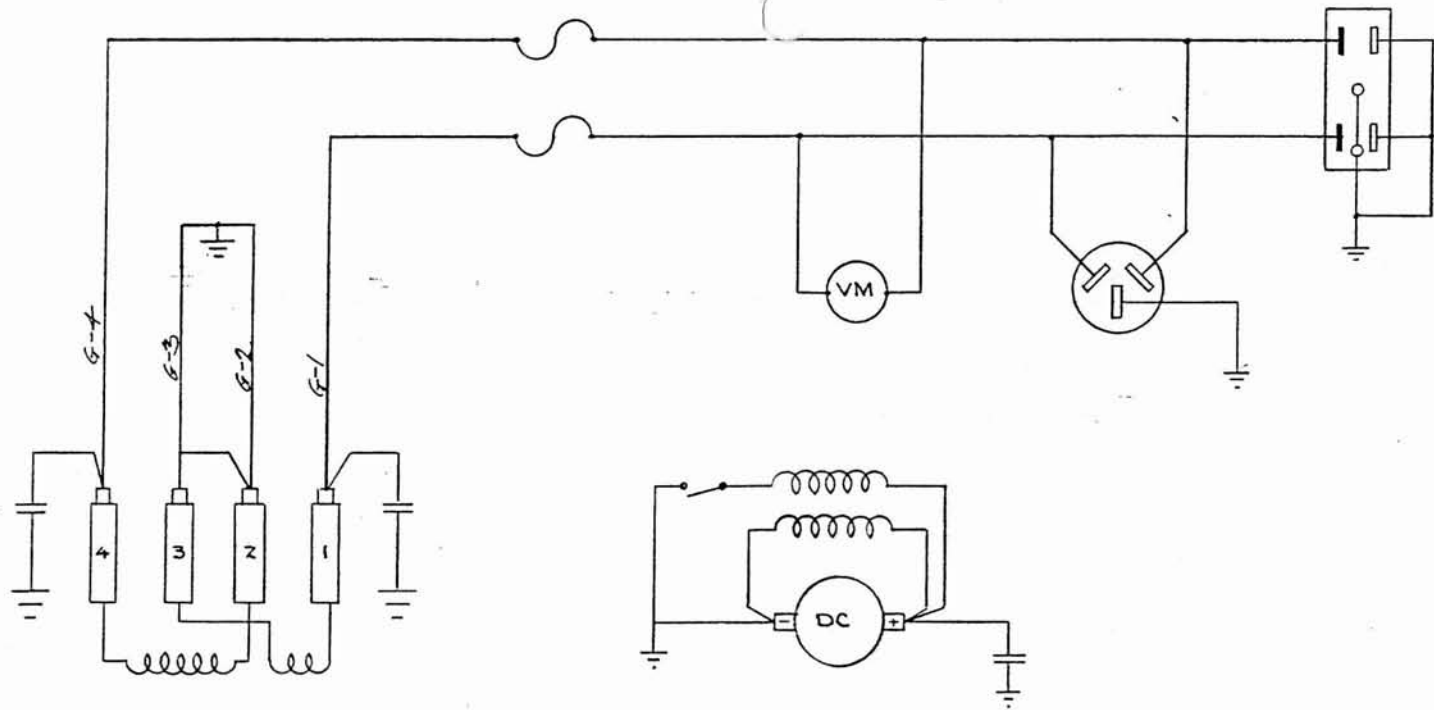

ALL DIMENSIONS GIVEN IN INCHES - WORK TO DIMENSIONS - DO NOT SCALE - SAMPLES MUST BE APPROVED BY WINCHARGER ENGINEERING DEPT BEFORE PROCEEDING WITH PRODUCTION - TOLERANCES (UNLESS OTHERWISE SPECIFIED): FRACTIONS $\pm 1/64$ DECIMALS $\pm .005$ PUNCHED HOLES $+ .004 - .000$									
DRAWN BY	DATE	CHKD BY	DATE	APPR'D BY	DATE	SCALE			
MASON	12-4-64	<i>[Signature]</i>	12-15-64	<i>[Signature]</i>	12-15-64	FULL			
MATERIAL									
FINISH							SCHEMATIC		
ASSY									
MOOBL 151XKPT0F-3/C									
1	ORIGINAL						WINCHARGER CORP.		B-50795
ISSUE	REVISION	DATE	BY	AUTH.	SIOUX CITY, IOWA				

GEAR CASE FOR TRACTOR DRIVEN PTO GENERATORS MODELS ENDING IN /B AND /C

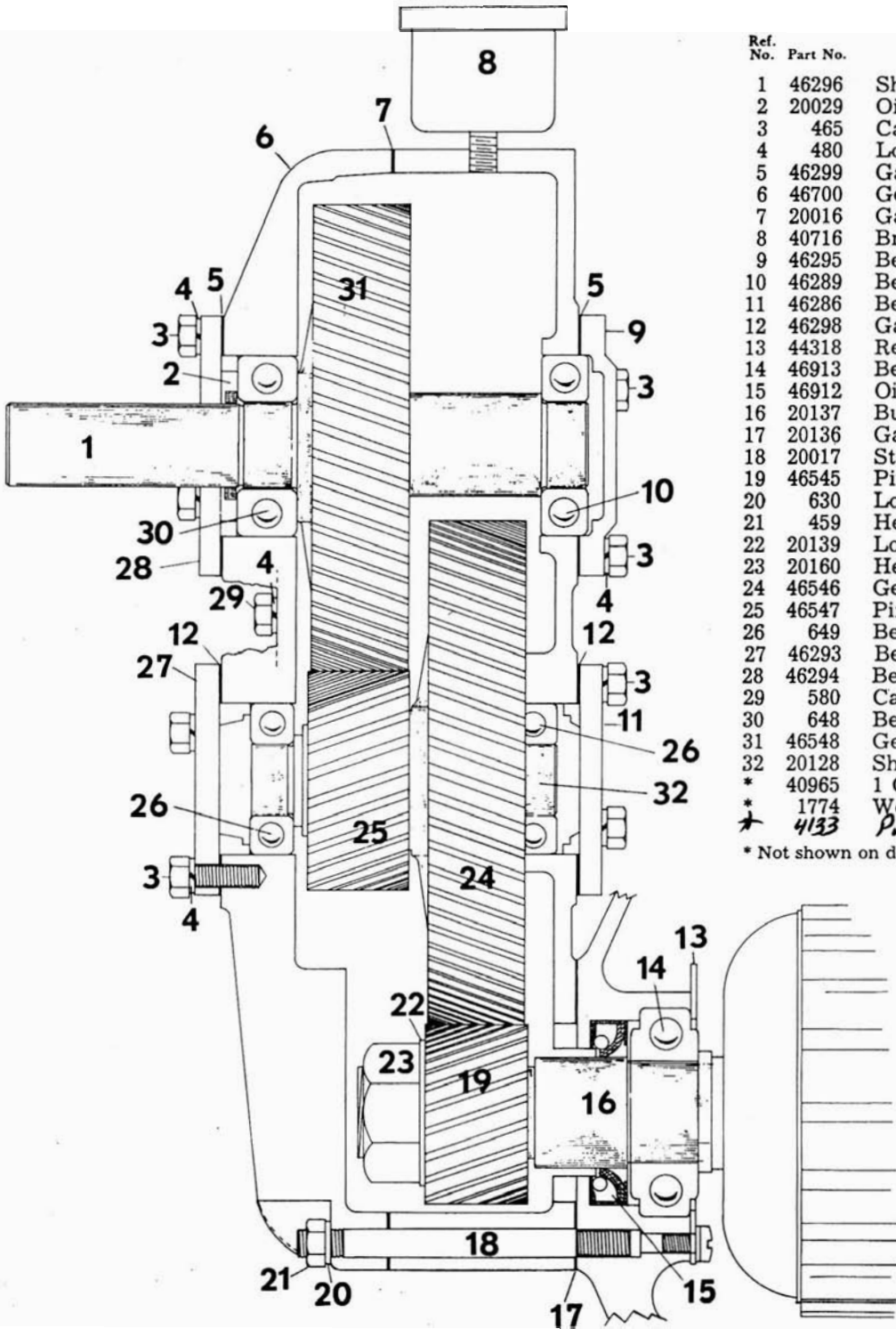

Ref. No.	Part No.	DESCRIPTION	Quantity
1	46296	Shaft	1
2	20029	Oil Seal	1
3	465	Cap Screw 5/16 - 18 x 7/8	12
4	480	Lockwasher 5/16"	24
5	46299	Gasket	2
6	46700	Gear Case & Cover	1
7	20016	Gasket	1
8	40716	Breather	1
9	46295	Bearing Retainer	1
10	46289	Bearing	1
11	46286	Bearing Retainer	1
12	46298	Gasket	2
13	44318	Retainer Plate	1
14	46913	Bearing	1
15	46912	Oil Seal	1
16	20137	Bushing	1
17	20136	Gasket	1
18	20017	Stud	3
19	46545	Pinion	1
20	630	Lockwasher	3
21	459	Hex Nut 3/8"	3
22	20139	Lockwasher	1
23	20160	Hex Jam Nut	1
24	46546	Gear	1
25	46547	Pinion	1
26	649	Bearing	2
27	46293	Bearing Retainer	1
28	46294	Bearing Retainer	1
29	580	Cap Screw 5/16 - 18 x 1 1/4	12
30	648	Bearing	1
31	46548	Gear	1
32	20128	Shaft	1
*	40965	1 Qt. Gear Oil	1
*	1774	Woodruff Key #15 (1/4 x 1")	4
†	4133	Pin	

* Not shown on drawing.