



ILLUSTRATED PARTS LIST

ULPSS21-3/B & /E

ULPSS21-4/B & /E

ULPSS21-17/B & /E

ULPSS21-18/B & /E

**WITH DSE 7310
ENGINE CONTROL**

**225 S. CORDOVA AVE.
LECENTER, MN 56057
507-357-6821
SERVICE DEPT.
507-357-6831
wincogen.com**

GENERATOR ASSEMBLY

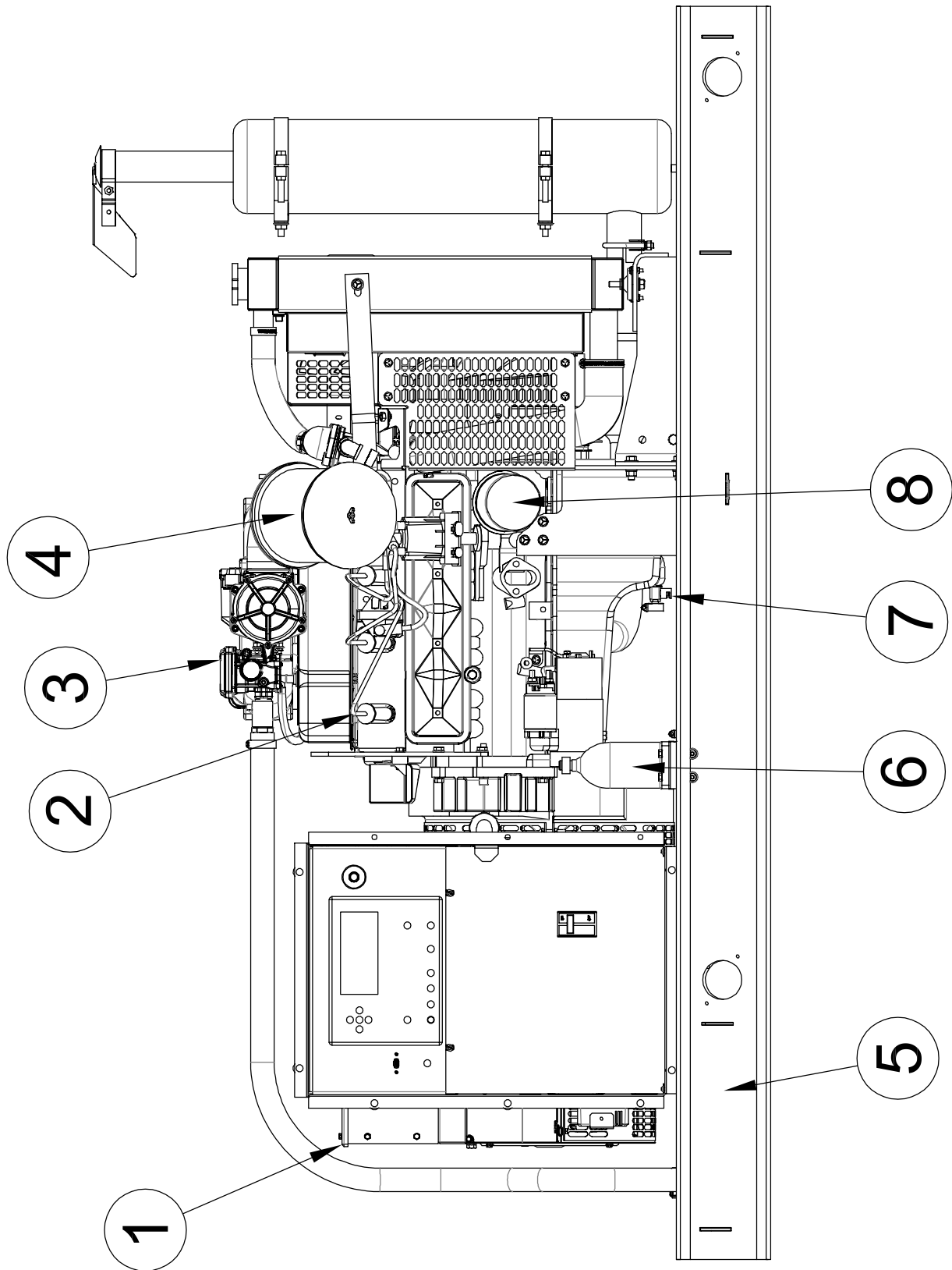

REF #	PART NUMBER	QTY	DESCRIPTION
1	SEE TABLE	1	Stamford Newage Generator
2	R42LTS	4**	Spark Plug
3	351987-1	1	3.0 L Certified GM Engine
4	F1-15UL	1*	Air Filter Assembly
5	99309-121	1	Base Assembly
6	99682-018	1	Block Heater Assembly
7	98906-006	1	Oil Drain Valve
8	PF454	1**	Oil Filter
NI	98956-001	4	Shock Mounts
NI	55505-000	3 FT	Oil Drain Hose
NI	99317-001	1	Battery Tray
NI	53220-036	1	Negative (-) Battery Cable
NI	53220-045	1	Positive (+) Battery Cable
NI	99420-021	1	DC Engine Harness
NI	350818-3	1	Voltage Regulator AS480UL
NI	72036-015	1	2 Amp Battery Charger
NI	16018-000	1	Air Filter Support
NI	62625-004	2 FT	Reflective Hose Sleeve
NI	Not Illustrated		
*	IMPCO Part #		
**	AC Delco Part #		

MODEL #	STAMFORD NEWAGE MODEL #	WINCO PART #
ULPSS21-3/B & /E	PI144D1J 4-LEAD	350005-012
ULPSS21-4/B & /E ULPSS21-17/B & /E ULPSS21-18/B & /E	PI144E1L 12-LEAD	350005-013

ENGINE CONTROL ASSEMBLY WITH DSE 7310

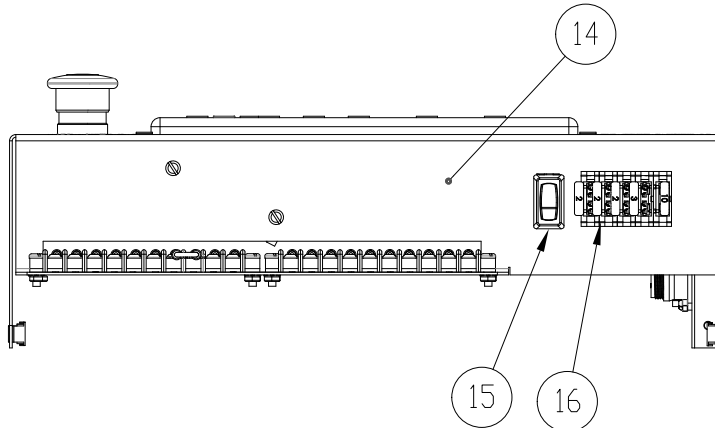
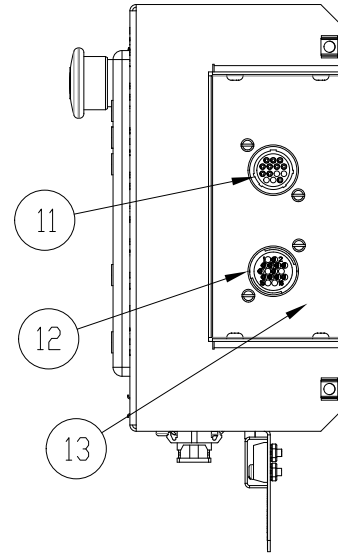
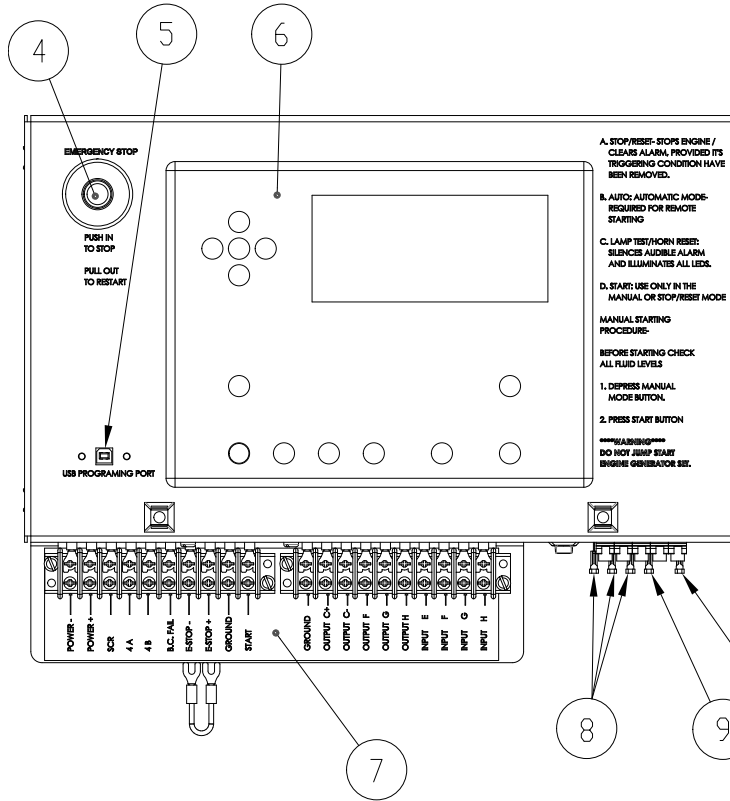
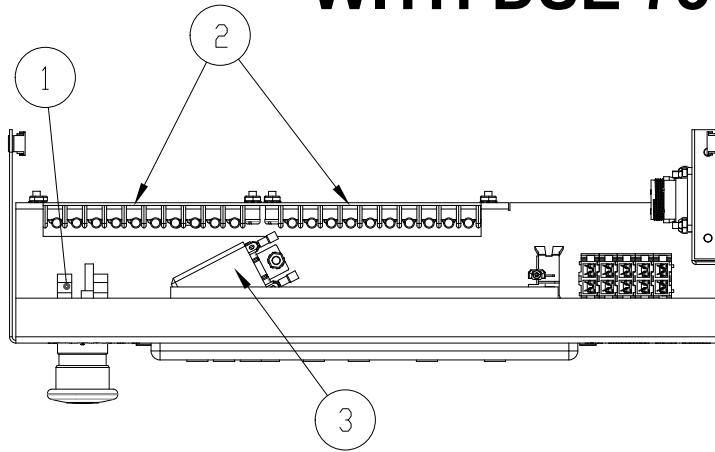

REF #	PART NUMBER	QTY	DESCRIPTION
1	99783-002	1	Switch Contact
2	80623-006	2	10 Point Terminal Block
3	59944-017	1	DPDT 12VDC 10 Amp Relay
4	99783-001	1	Push Pull Switch
5	92844-005	1	USB Cable
6	351112-4	1	DSE 7310 Controller
7	351095-11	1	Terminal Strip Decal
8	95064-102	3	2 Amp 32VDC Fuse
9	95064-103	1	3 Amp 32VDC Fuse
10	95064-110	1	10 Amp 32VDC Fuse
11	96925-002	1	14 Pin Connector
12	96925-006	1	16 Pin Connector
13	351900-11	1	Connector Plate
14	351900-22	1	Engine Control Panel
15	64089-000	1	SPST Rocker Switch
16	2489-002	5	Fuse Holder

CONTROL CABINET ASSEMBLY

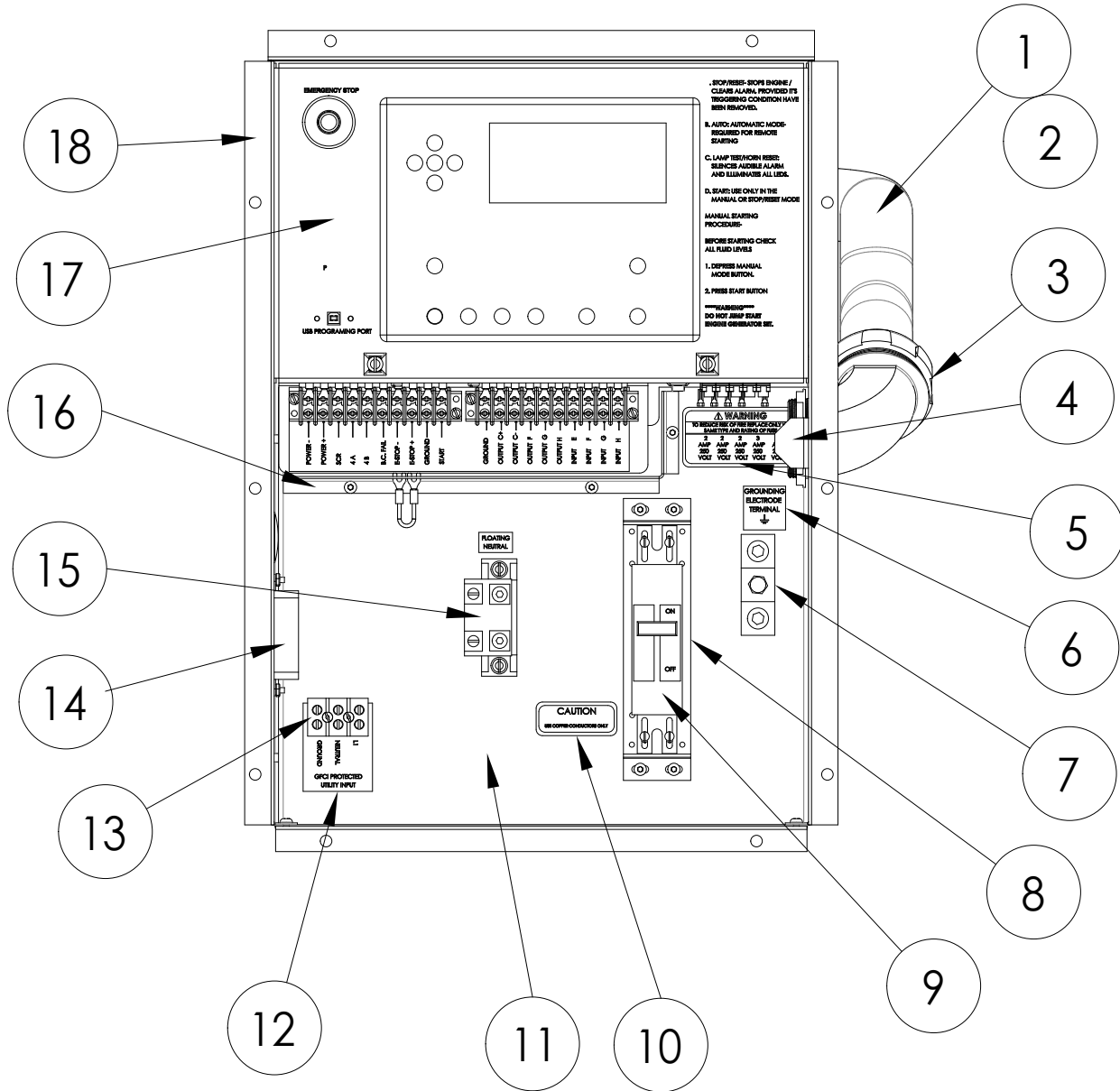

REF #	PART NUMBER	QTY	DESCRIPTION
1	16522-000	1	2" Straight Conduit Connector
2	16523-004	20"	Flexible Conduit
3	16522-001	1	2" 90° Conduit Connector
4	99826-194	1	Door Latch
5	63941-015	1	Fuse Warning Decal
6	16499-000	1	Ground Decal
7	58060-000	2	Ground Lug
8	SEE TABLE	1	Circuit Breaker Riser
9	SEE TABLE	1	Circuit Breaker
10	16503-000	1	Copper Connector Decal
11	SEE TABLE	1	Circuit Breaker Panel
12	64576-006	1	GFCI Protected Decal
13	51795-000	1	3 Point Terminal Block
14	24749-000	1	NEMA 5-15R Receptacle
15	350124-3	1	Neutral Assembly
16	99826-098	1	DC Box
17	99775-015	1	DSE Control Assembly
18	99826-130	1	Control Cabinet
NI	300538-23	1	Wiring Harness Kit
NI	SEE TABLE	1	Circuit Breaker Cover Panel
NI	Not Illustrated		

WINCO MODELS	PART NUMBER	DESCRIPTION
ULPSS21-3/B & /E	92072-000 58805-005 92076-020 99826-220	CB RISER 90 AMP 2-POLE BREAKER CB PANEL CB COVER PANEL
ULPSS21-4/B & /E	92072-002 82584-001 92076-021 99826-221	CB RISER 70 AMP 3-POLE BREAKER CB PANEL CB COVER PANEL
ULPSS21-17/B & /E	92072-002 82584-001 92076-021 99826-221	CB RISER 70 AMP 3-POLE BREAKER CB PANEL CB COVER PANEL
ULPSS21-18/B & /E	81097-052 92076-022 99826-123	35 AMP 3-POLE BREAKER CB PANEL CB COVER PANEL

VAPOR FUEL SYSTEM ASSEMBLY

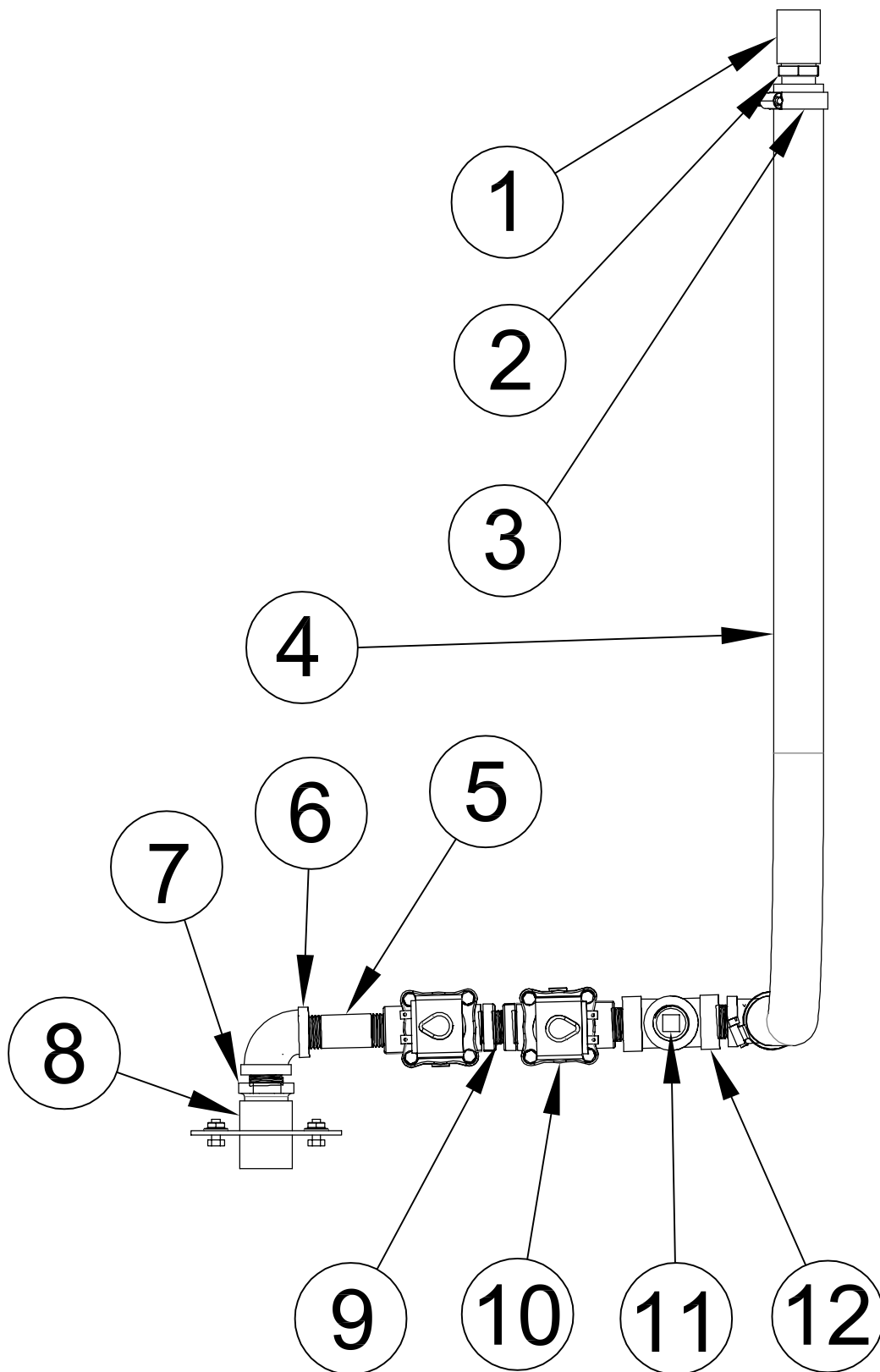

REF #	PART NUMBER	QTY	DESCRIPTION
1	22766-000	1	¾" Pipe Coupling
2	92388-004	2	Hose Fitting
3	81018-004	2	Hose Clamp
4	49409-012	56"	1" I.D. Propane Hose
5	54074-001	1	¾" X 3-1/2" Pipe Nipple
6	50244-000	2	90° Pipe Elbow
7	81077-000	1	1" X ¾" Reducer
8	99065-000	1	Fuel Weldment
9	54074-006	4	¾" X 1-1/2" Pipe Nipple
10	42942-000	2	Solenoid
11	93564-000	1	Pipe Plug
12	94907-000	1	¾" X ¾" X ¾" Pipe Tee

GEN-END ASSEMBLY

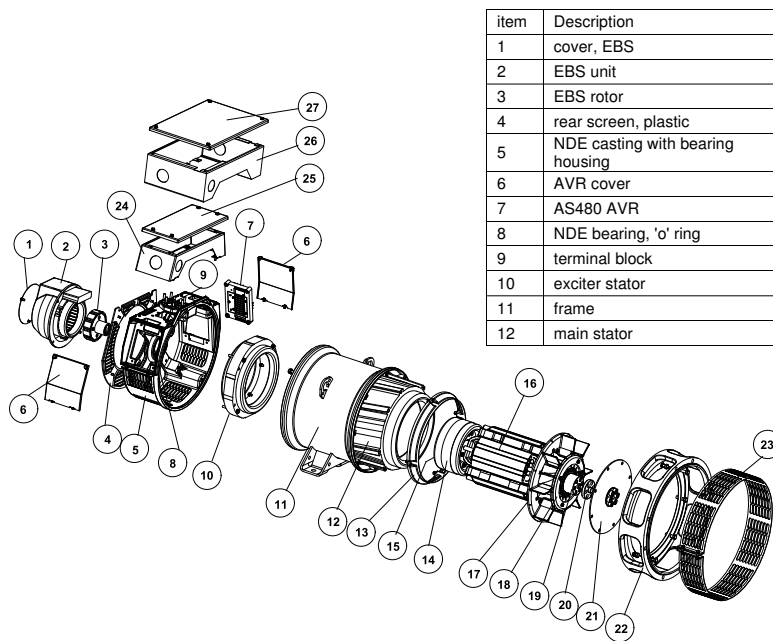

item	Description
1	cover, EBS
2	EBS unit
3	EBS rotor
4	rear screen, plastic
5	NDE casting with bearing housing
6	AVR cover
7	AS480 AVR
8	NDE bearing, 'o' ring
9	terminal block
10	exciter stator
11	frame
12	main stator

13	air flow baffle
14	exciter rotor
15	rotating rectifier assembly
16	main rotor assembly
17	fan, removable
18	fan hub, fixed
19	shaft
20	shaft spacer
21	coupling disc
22	DE adapter
23	DE screen
24	standard terminal box
25	standard terminal box lid
26	large terminal box
27	large terminal box lid

N.D.E. Non Driven End
D.E. Driven End
A.V.R. Automatic Voltage Regulator

LP LIQUID WITHDRAWAL ASSEMBLY

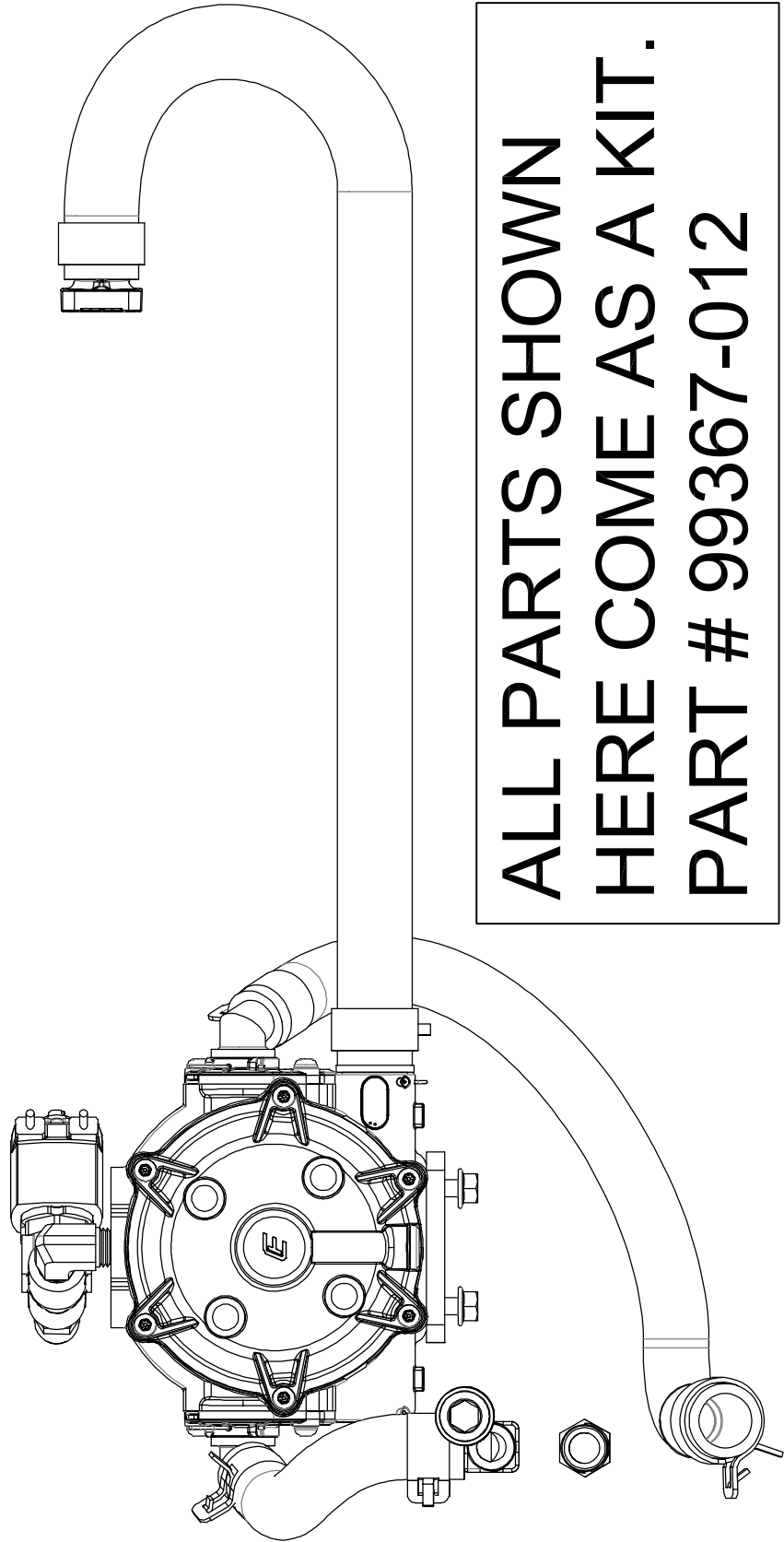

ALL PARTS SHOWN
HERE COME AS A KIT.
PART # 99367-012

EXHAUST ASSEMBLY

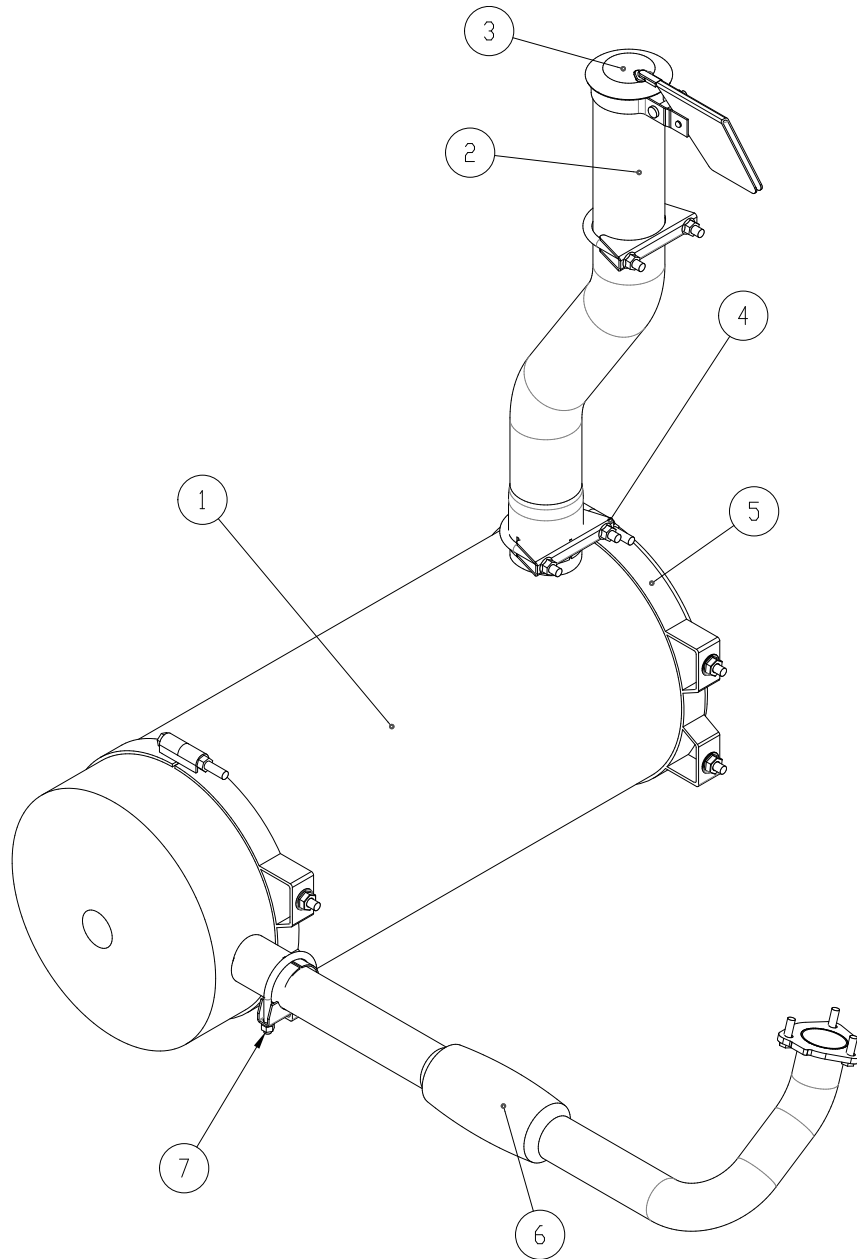

REF #	PART NUMBER	QTY	DESCRIPTION
1	80519-016	1	Muffler
2	99298-030	1	Tail Pipe
3	53111-008	1	3" Rain Cap
4	93489-001	2	3 3/8" Muffler Clamp
5	350264-3	2	12" Exhaust Clamp
6	99298-029	1	Flex Pipe
7	93489-011	1	2 1/4" Muffler Clamp

GENERATOR MODIFICATION ASSEMBLY

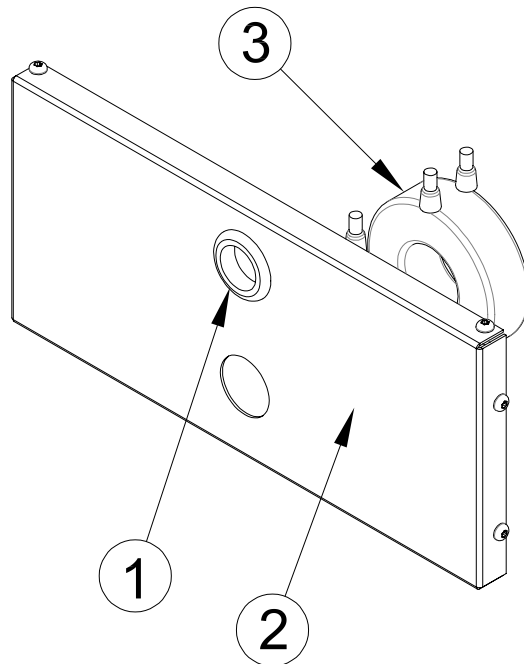

REF #	PART NUMBER	QTY	DESCRIPTION
1	62486-000	1	Grommet
2	64702-003	1	Generator Front Panel
3	SEE TABLE	2 or 3	Current Transformer
NI	SEE TABLE	1	AC Harness Assembly
NI	Not Illustrated		

MODEL #	PART #	QTY	DESCRIPTION
ULPSS21-3/B & /E	80124-004	2	150 to 5 Amp Current Transformer
ULPSS21-4/B & /E ULPSS21-17/B & /E ULPSS21-18/B & /E	80124-004	3	150 to 5 Amp Current Transformer

MODEL #	PART #	QTY	DESCRIPTION
ULPSS21-3/B & /E	99347-014	1	AC Harness
ULPSS21-4/B & /E ULPSS21-17/B & /E ULPSS21-18/B & /E	99347-015	1	AC Harness

HOUSING ASSEMBLY

RIGHT SIDE

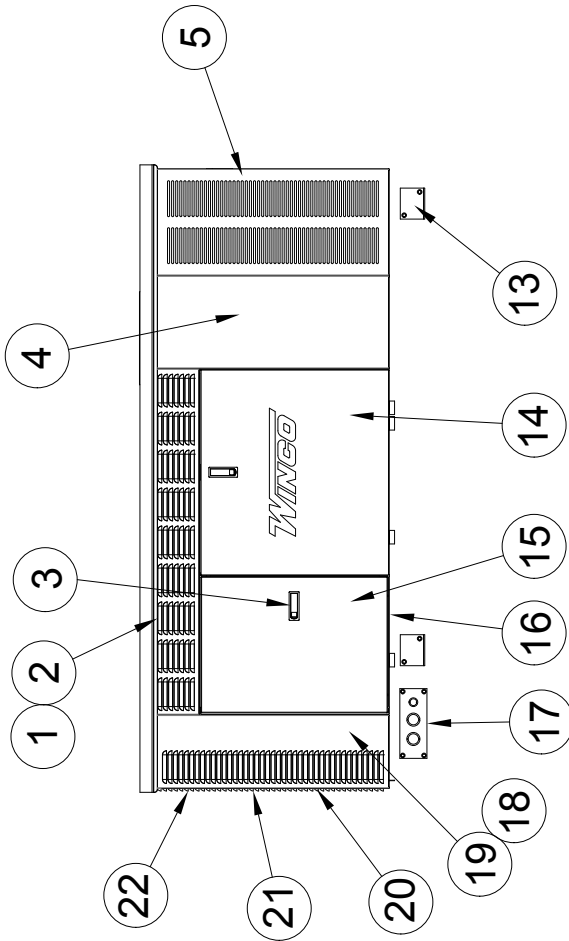

LEFT SIDE

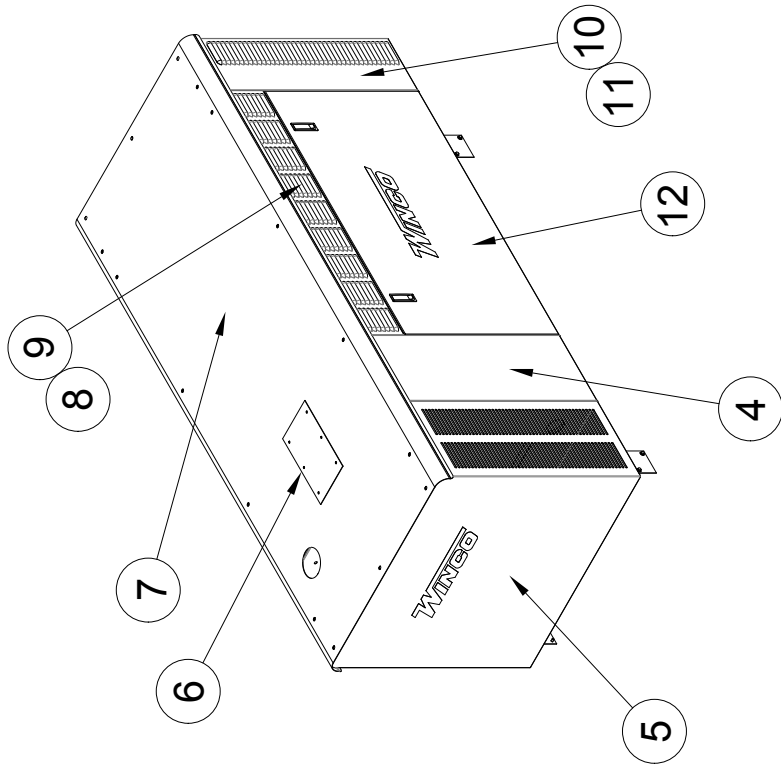

REF #	PART NUMBER	QTY	DESCRIPTION
1	99078-023S	1	Right Side Sill
2	99378-120S	1	Right Side Sill Baffle
3	95229-005	4	Door Latch
4	99071-041S	1	Radiator Housing
5	99071-040	1	Front Housing
6	99515-013S	1	Roof Access Cover
7	99515-021	1	Roof
8	99078-024S	1	Left Side Sill
9	99378-121S	1	Left Side Sill Baffle
10	99067-033S	1	Left Rear Corner
11	99378-132S	1	Left Rear Baffle
12	99100-041S	1	Left Side Panel
13	99060-000S	4	Frame Cover Plate
14	99100-024S	1	Right Side Panel
15	15680-058S	1	Door
16	99333-018S	1	Door Stop
17	99060-010S	1	Conduit Plate
18	99067-034S	1	Right Rear Corner
19	99378-131S	1	Right Rear Sill
20	99100-070S	1	Rear Sill
21	99378-130S	1	Rear Sill Baffle
22	99100-071S	1	Rear Center Panel
NI	99225-006S	2	Roof Support
NI	98375-031	1	Hinge
NI	99095-031	1	Foam Kit
NI	91682-002	6	Stud ¼ Turn - Bail Style
NI	91683-000	6	Recpt. Turn - Clip Nut
NI	91684-000	6	Retainer ¼ Turn - Split Ring
NI	95706-000	55"	1" Foam Strip
NI	62912-002	2 FT	3/8" Wide X 1/16" Foam Strip
NI	62912-000	7 FT	½" Wide X 1/8" Foam Strip
NI	Not Illustrated		

ACOUSTIC FOAM PIECES

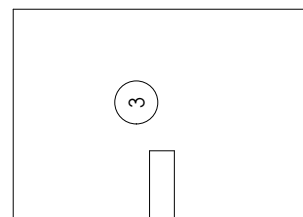
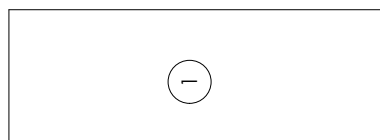
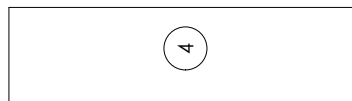
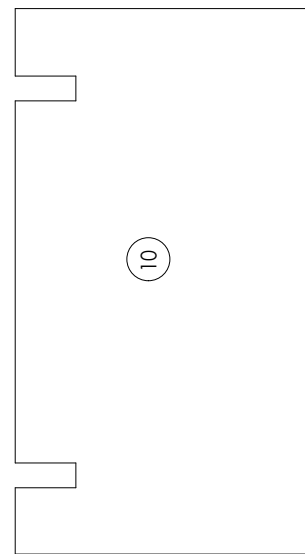
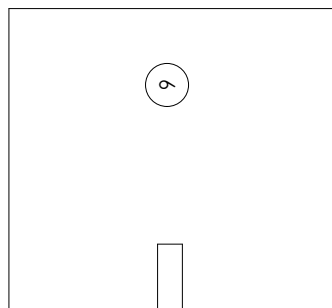
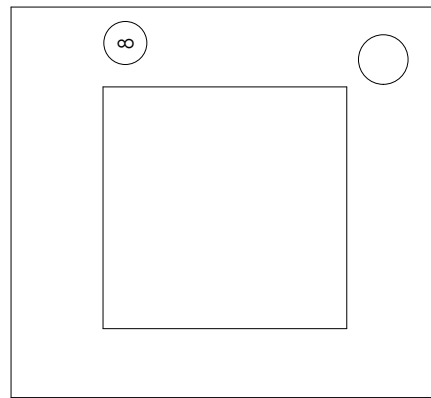
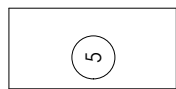
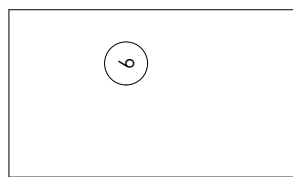

REF #	PART #	QTY	DESCRIPTION			
1	99393-133S	2	Radiator Housing Sides			
2	99393-134S	2	Side Sill Foam			
3	99393-137S	1	Door Foam			
4	99393-138S	2	Rear Baffle Foam			
5	99393-139S	1	Rear Sill Foam			
6	99393-140S	1	Rear Panel Foam			
7	99393-148S	1	Roof Foam			
8	99393-145S	1	Radiator Housing Foam			
9	99393-146S	1 <td Right Side Panel Foam	10	99393-147S	1	Left Side Panel Foam
10	99393-147S	1	Left Side Panel Foam			

BLOCK HEATER ASSEMBLY

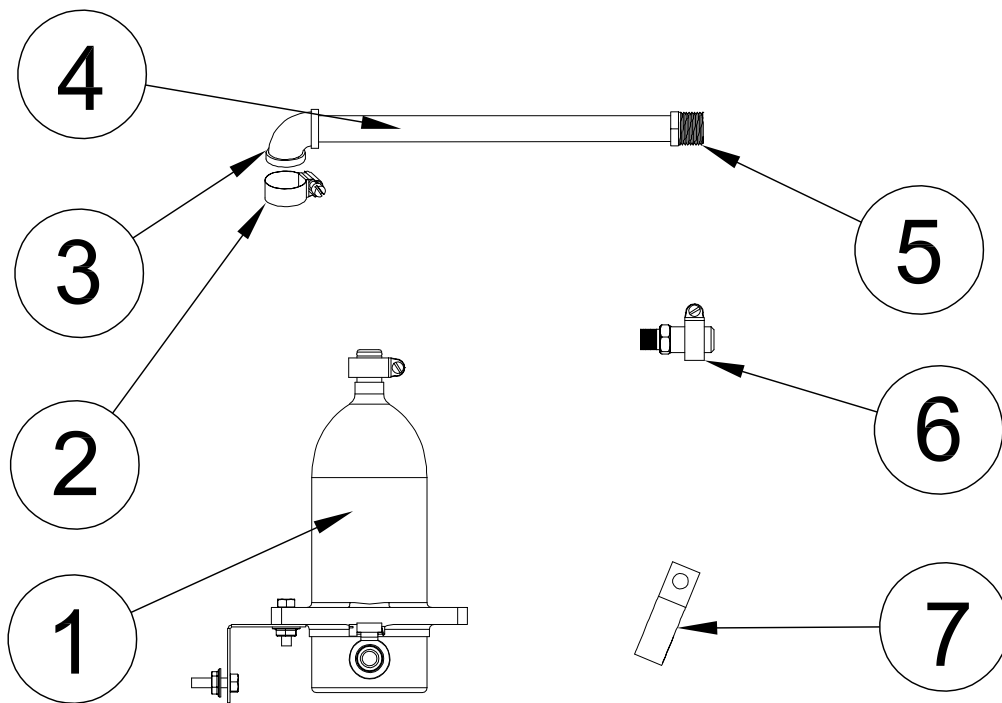

REF #	PART NUMBER	QTY	DESCRIPTION
1	80781-003	1	1000W 120V Tank Heater
2	81018-005	4	Hose Clamp
3	53196-000	1	3/8" Pipe Elbow
4	16456-012	1	3/8" X 10" Pipe Nipple
5	56372-000	1	Reducer
6	350341	1	Hose Fitting
7	97391-008	1	Tube Clamp
NI	93689-001	8 FT	5/8" Hose
NI	Not Illustrated		

ULPSS21-3/B & /E

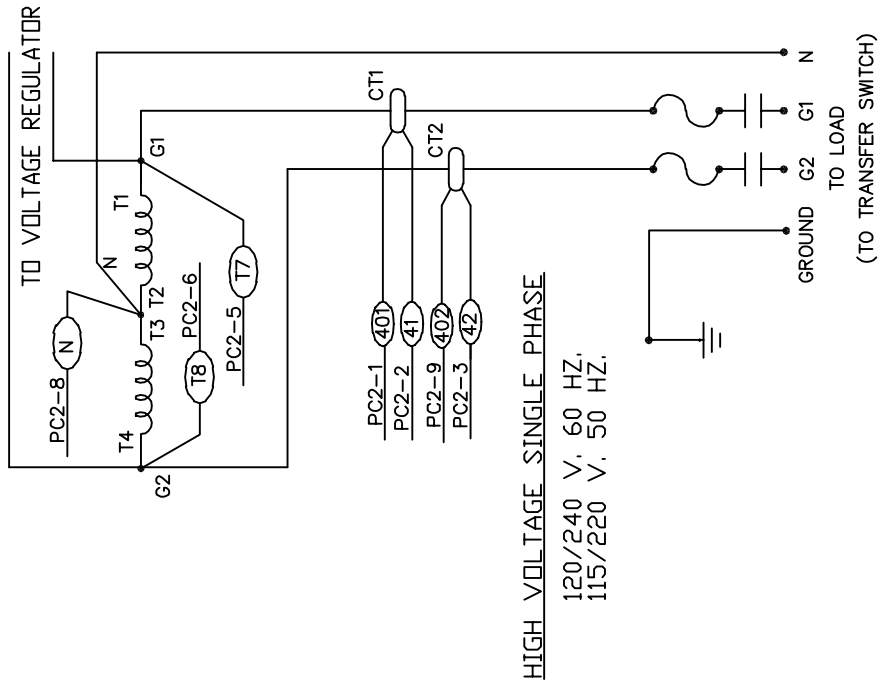

AC WIRING SCHEMATICS

ULPSS21-18/B & /E

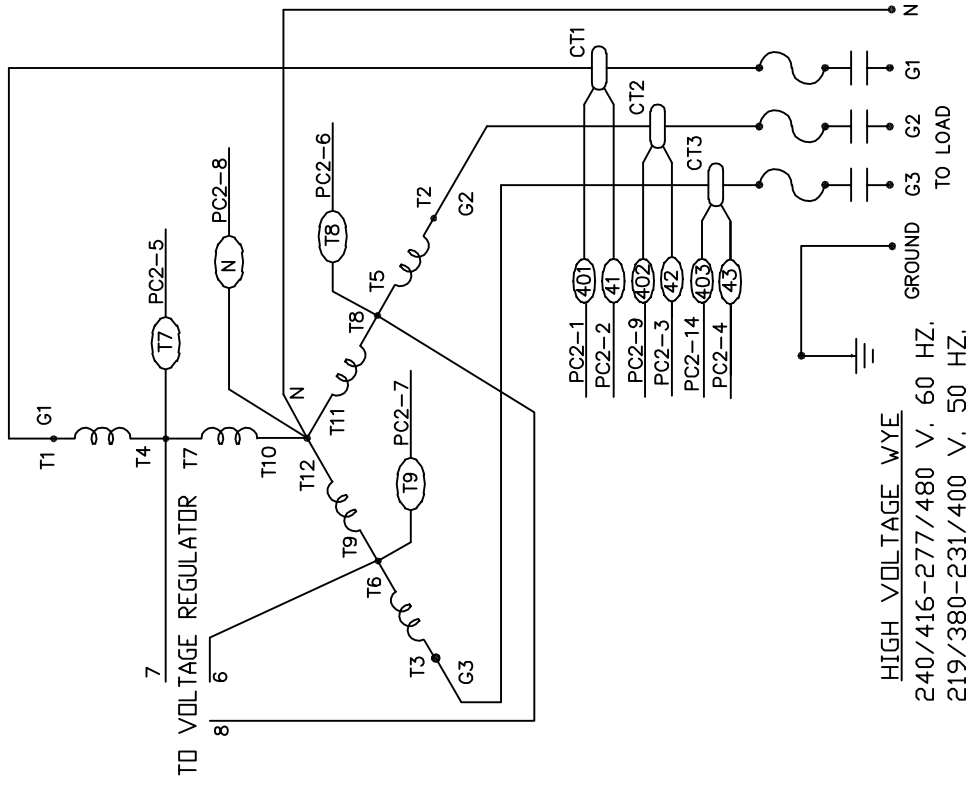

ULPSS21-4/B & /E

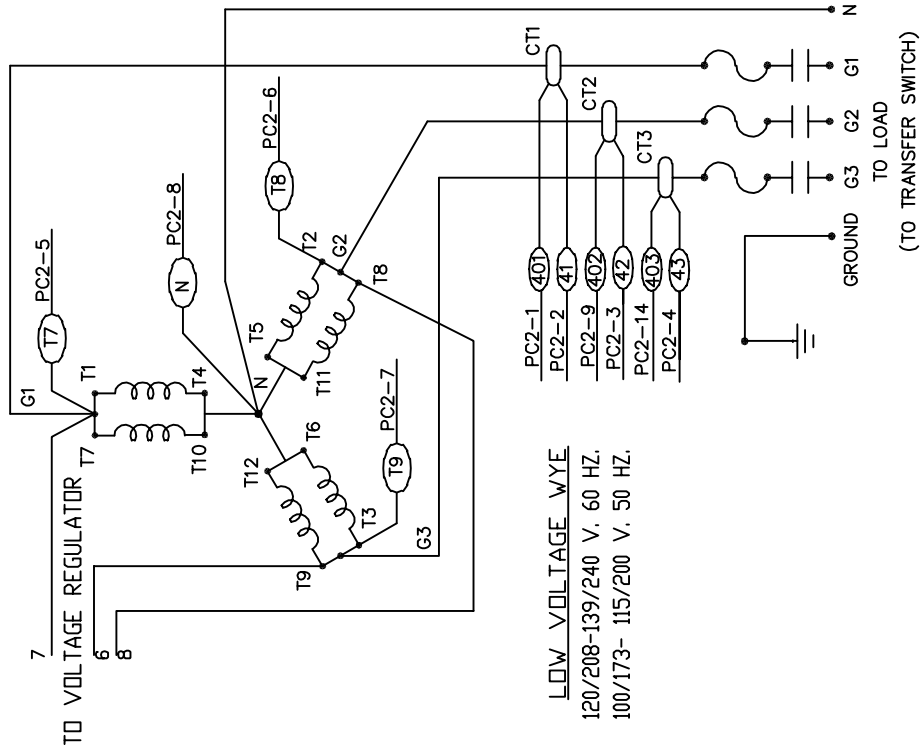

ULPSS21-17/B & /E

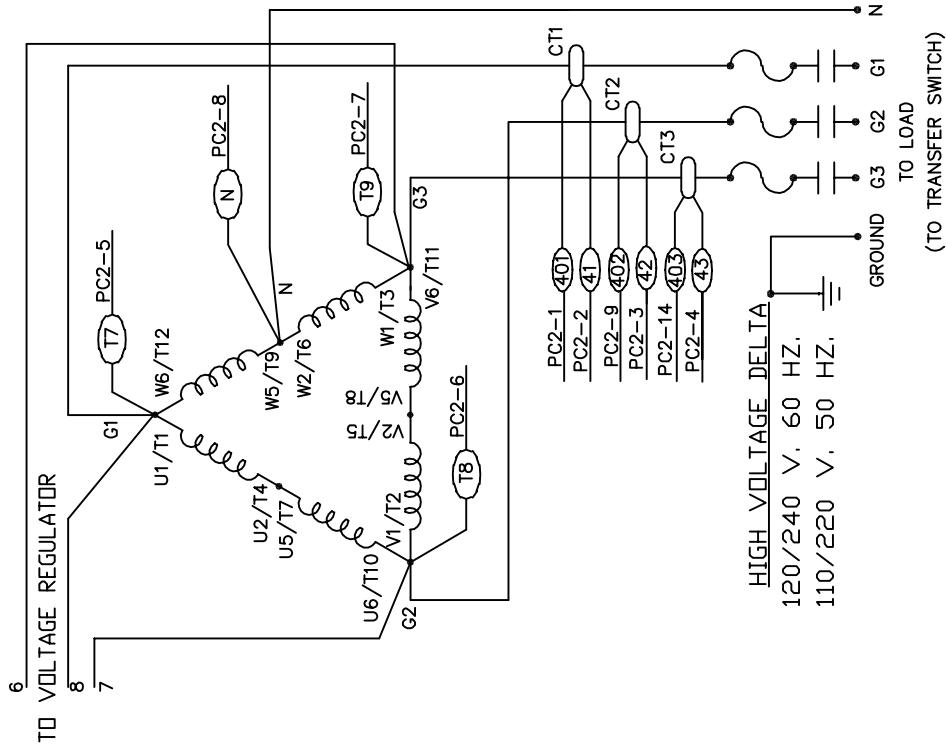

DC WIRING SCHEMATIC DSE 7310

