

91287-024

ITEM NO.	PartNo	DESCRIPTION	QTY.
1	100046-503	CARTON 55-75 PTO	1
2	100047-122	CARTON 8 X 8 X 4	1
3	100054-652	BAG 21 X 14.5 X 20 2 MIL	1
4	15209-003	UL-DECAL ELECTRICAL SHOCK CAN KILL	1
5	15750-001	GROUND DECAL	1
6	16303-000	DECAL- OIL LEVEL	1
7	21698-001	TORX PAN HEAD SCREW #10	32
8	21867-000	FLAT WASHER	2
9	44791-000	TERMINAL CLOSED CONNECTOR	2
10	468-000	.3125-18X1.5 HHCS	1
11	47136-000	HEX NUT .3125-18 NYLOK	1
12	473-000	HHCS .3125-18 X .5 GR5 ZINC	4
13	480-000	LOCK .3125 SPLIT	4
14	48043-000	TERMINAL GROUND	1
15	49975-010	CABLE TIE	2
16	52077-000	DECAL-CAUTION OIL LEVEL	1
17	52126-082	LWA 12GA WHITE	1
18	526-000	FLAT WASHER 5/16_3/8	5
19	53644-000	10-24 X 3/8 SELF TAPPING	7
20	55224-000	LOCK WASHER 5/16 EXTERNAL TOOTH	1
21	60706-198	OPR.MANUAL 35-75PTO	1
22	63966-007	KIT, NAMEPLATE WINCO PTO	1
23	64515-000	DECAL- WARNING PTO	1
24	81582-015	LWA 2GA BLACK	1
25	8472-000	FLAT WASHER 7/16 X 1" OD	4
26	90570-000	LOCK WASHER 7/16 SPLIT	6
27	91171-000	SHIELD	1
28	91174-002	COVER	1
29	91178-000	BRACKET ASSEMBLY	1
30	91256-000	.4375-14X1.75 HHB	6
31	91258-049	CONNECTION BOX ASSY	1
32	91291-001	GENERATOR AND GEARCASE ASSY	1
33	91369-001	DECAL- 1000 RPM	1
34	91397-000	FIELD FORCING TRANSFORMER ASSEMBLY	1
35	91400-000	STRAP-TRANSFORMER MNT	1
36	91436-000	STRAP-TRANSFORMER MNT	1
37	91443-007	SLEEVING, 3/4", FIBERGLASS (7.000")	1
38	91861-004	PLUG KIT	1
39	98479-000	WINCO #1 WORLDWIDE DECAL	2
40	40965-000	GEAR OIL	1PT

REVISIONS					
REV.	IRN	DESCRIPTION	DATE	BY	APP'D
C	6872	RPLCD 91397-002 WITH 91397-000 & ADDED MOUNTING HARDWARE FROM 91258-049	3/27/2017	SJM	DRC

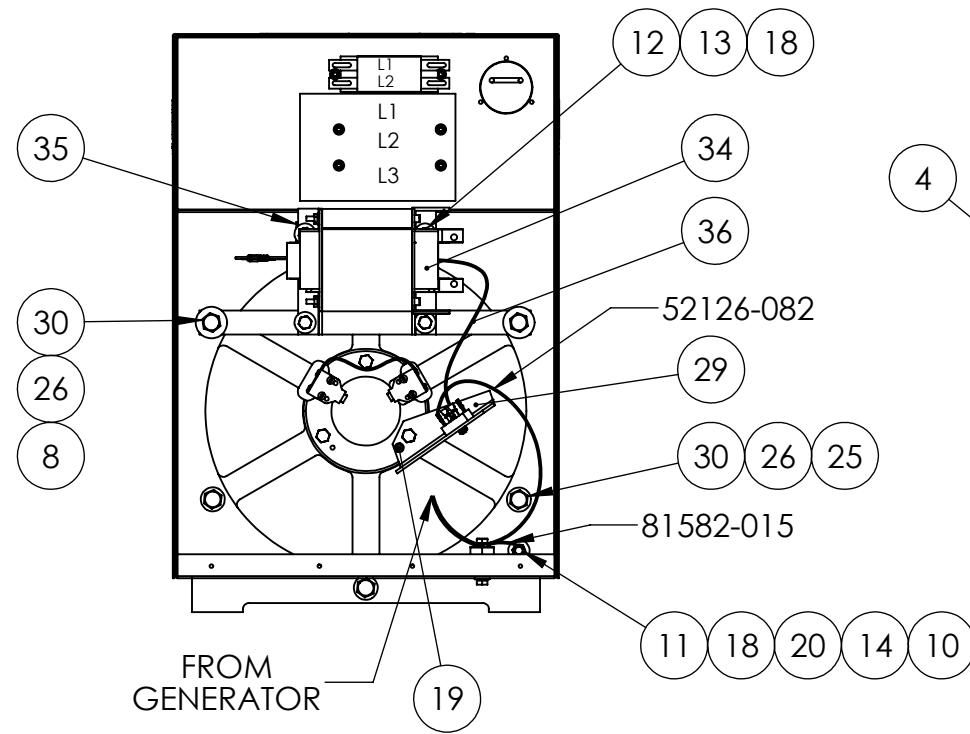

NOTE: SEE CONNECTION BOX ASSEMBLY 91258-049 PRINT FOR WIRING DETAILS

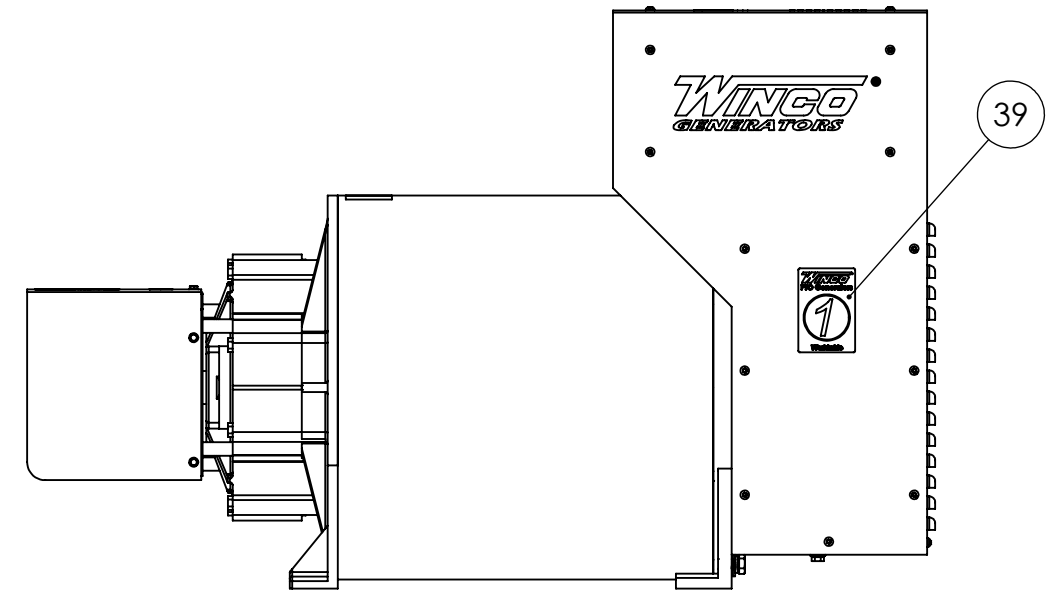
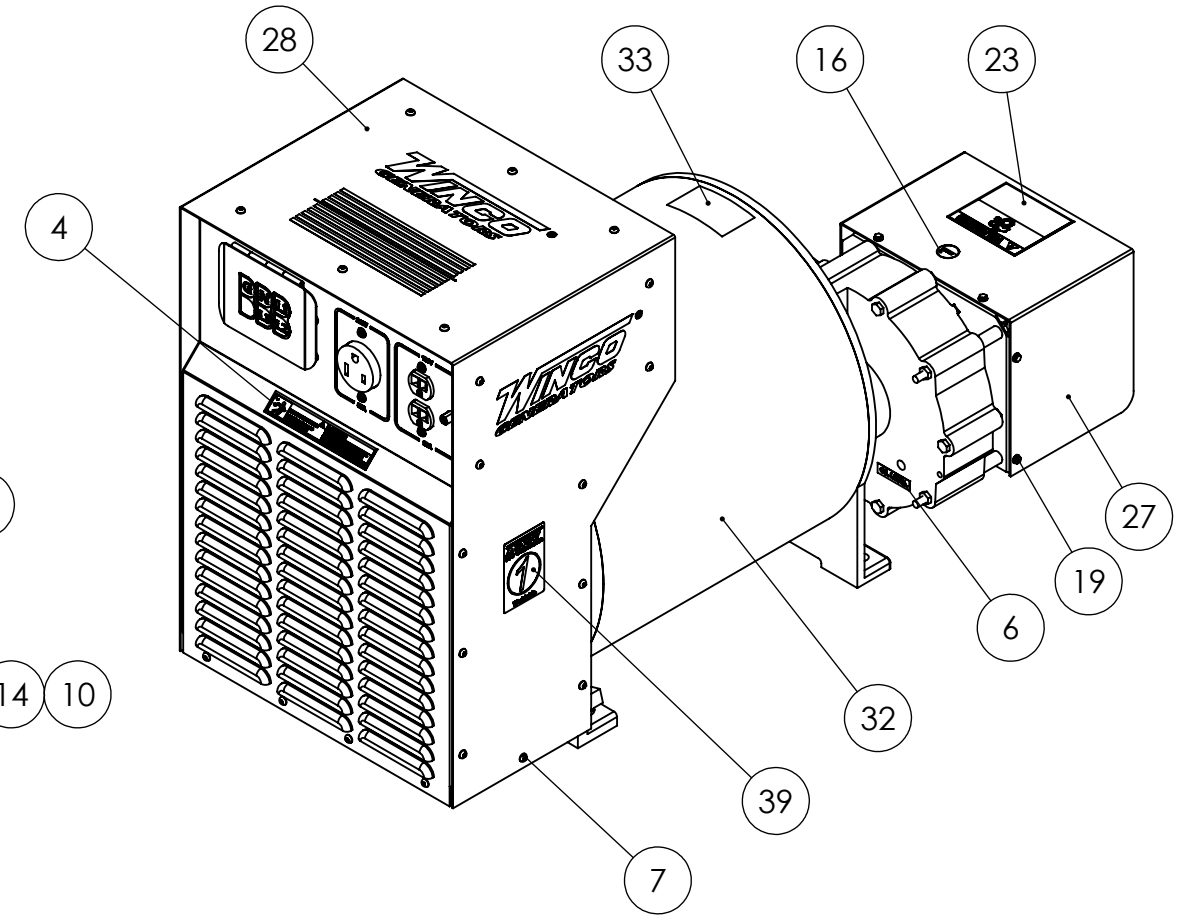
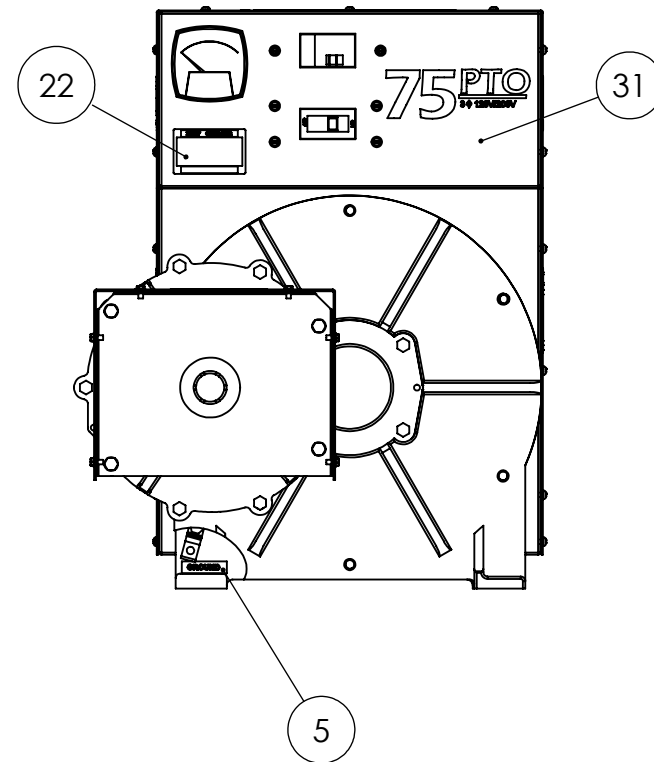

 THIS DRAWING CONTAINS PROPRIETARY INFORMATION BELONGING TO WINCO. UNAUTHORIZED USE IS PROHIBITED. ALL DIMENSIONS INCH	DRAWN BY	DATE	CHK'D BY	DATE	ENG APPR.	DATE
	RLC	11/30/2010				
	TOLERANCE:	+/- 0.0625 DECIMAL		TITLE: COMPLETE ASSEMBLY		
	MODEL:	75FPTOC-17/E		PART: 91287-024		