

069-0

REVISIONS					
REV.	IRN	DESCRIPTION	DATE	BY	APP'D
A	DR250_DR300	NEW PART	4/7/2025	VP	DRC

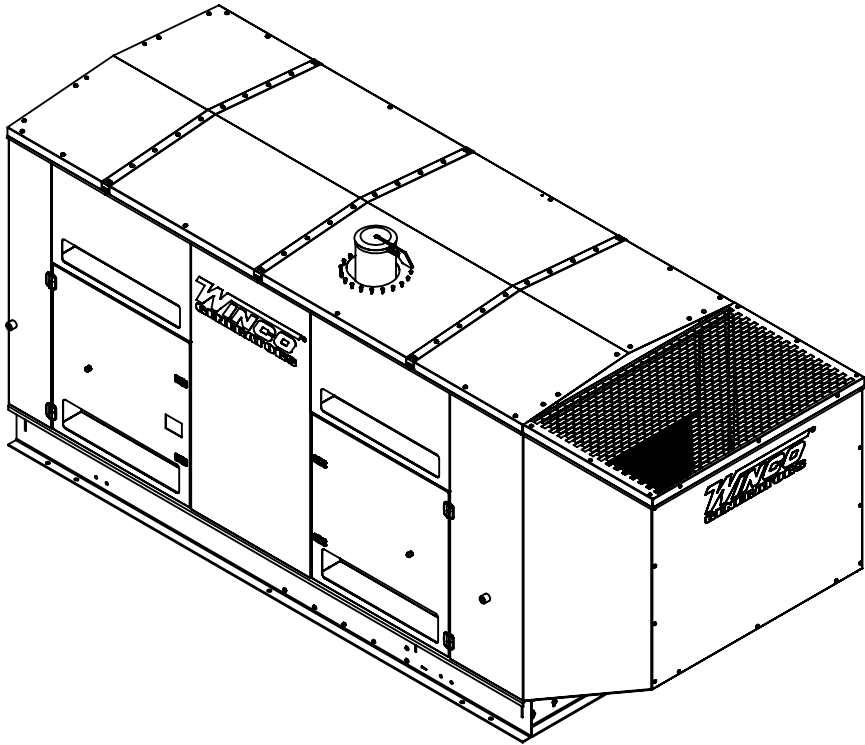
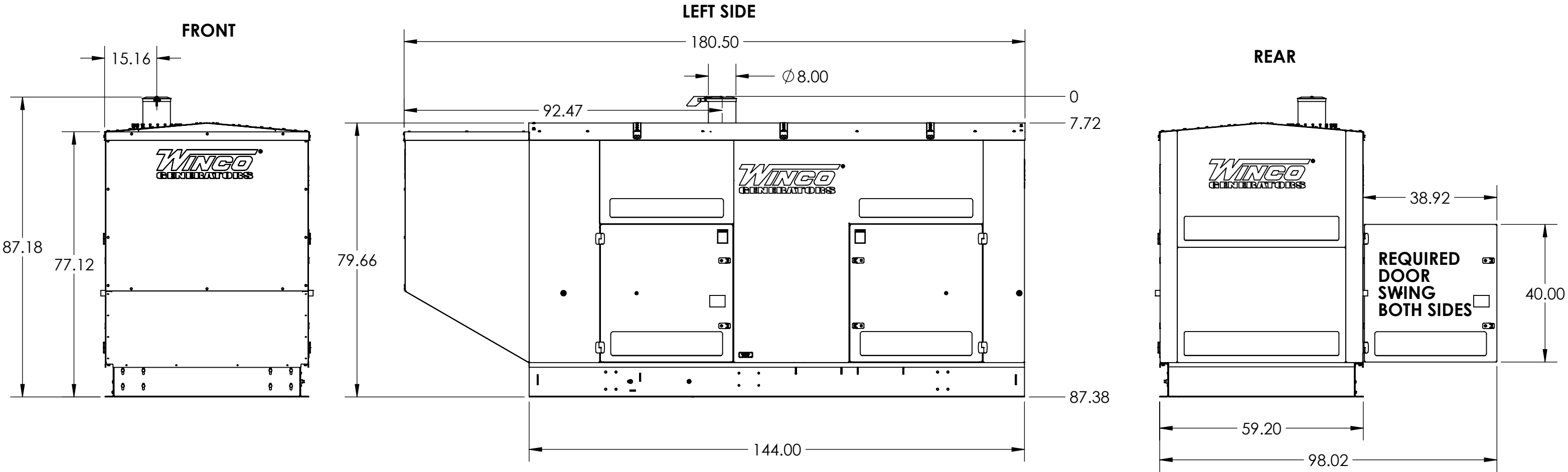

* SEE FUEL TANK DRAWINGS FOR CRITICAL LAYOUT INFORMATION *

APPROX. WEIGHT NO TANK: 8740 LBS

THIS DRAWING CONTAINS PROPRIETARY INFORMATION BELONGING TO WINCO. UNAUTHORIZED USE IS PROHIBITED	TOLERANCE:	+/- 0.0625 DECIMAL +/- 1 DEG ANGULAR	TITLE: OUTLINE DRAWING, DR250F4-XX_2 AND DR300F4-XX_2
	WEIGHT:	LBS	
	MODEL:	DR250_DR300	
ALL DIMENSIONS INCH ALL WEIGHT POUNDS		WINCO ®	PART: 0-590 1 of 2

069-0	
KEY COMPONENTS	
A	ENGINE CONTROL
B	MAIN LINE CIRCUIT BREAKER
C	OIL FILL
D	OIL DRAIN
E	OIL DIPSTICK
F	OIL FILTER
G	FUEL FILTER
H	FUEL INLET
I	AIR FILTER
J	COOLANT DRAIN
K	COOLANT FILL
L	AVR
M	BATTERY CHARGER
N	BLOCK HEATER
O	BATTERY

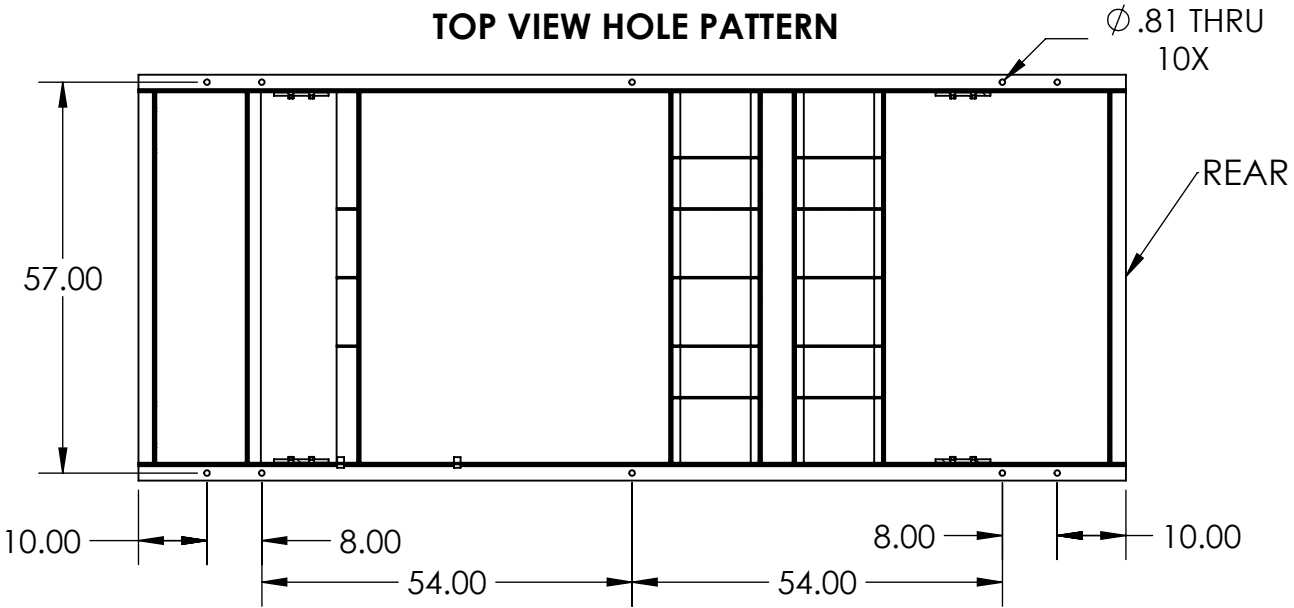

REVISIONS					
REV.	IRN	DESCRIPTION	DATE	BY	APP'D
A	DR250_DR300	NEW PART	4/7/2025	VP	DRC

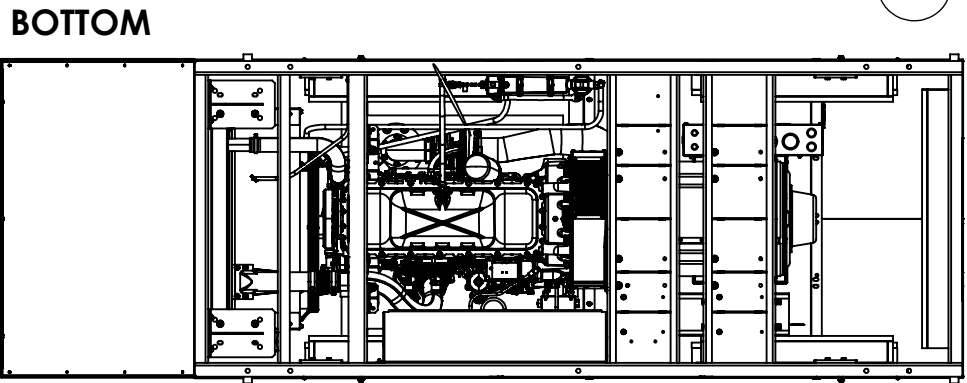
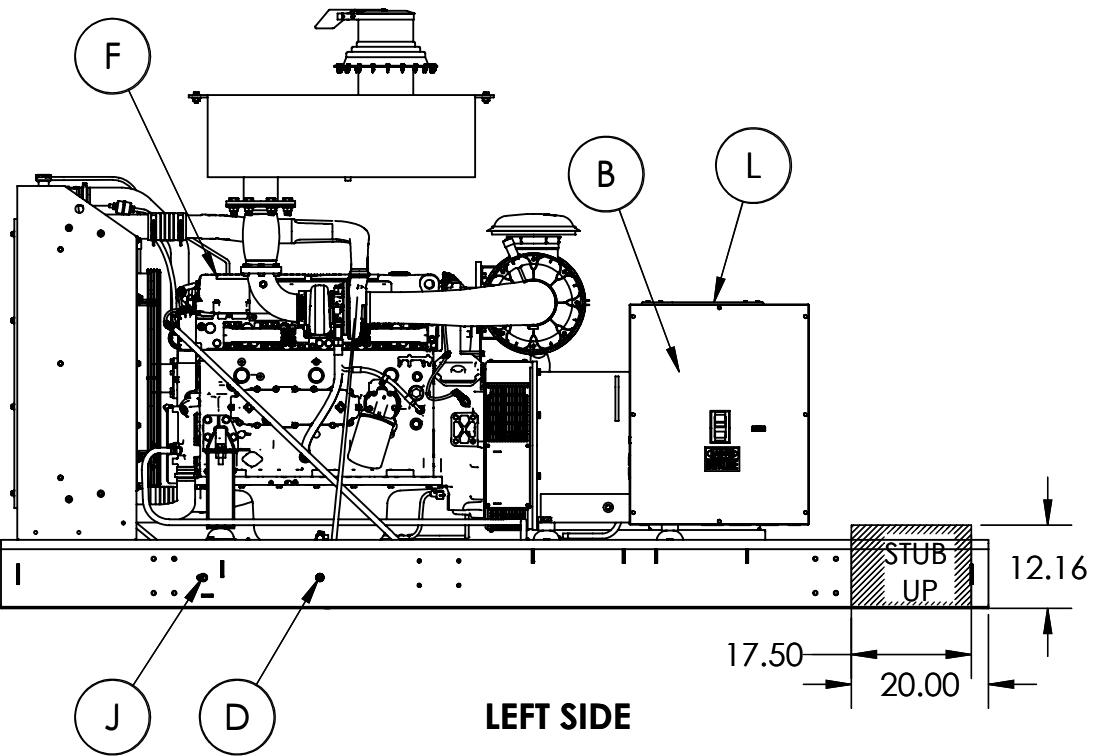
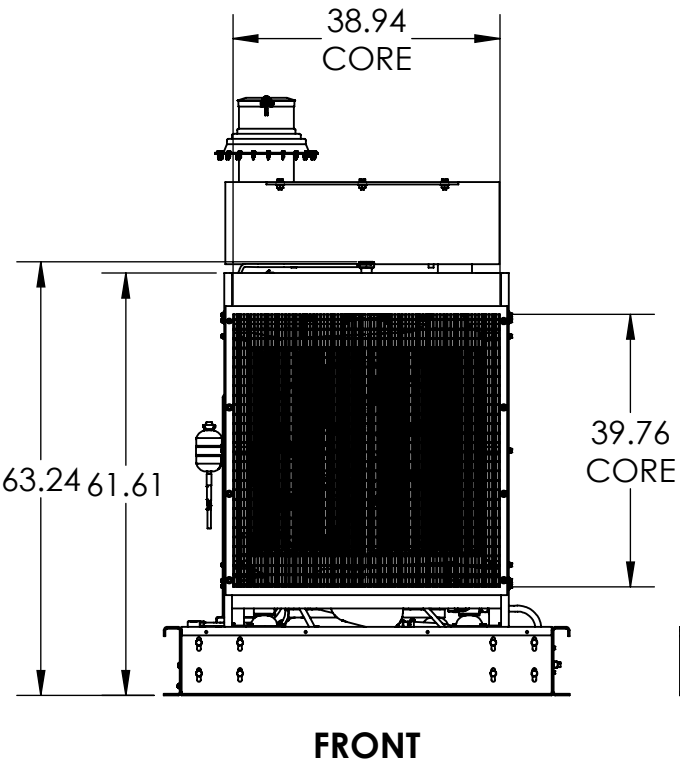
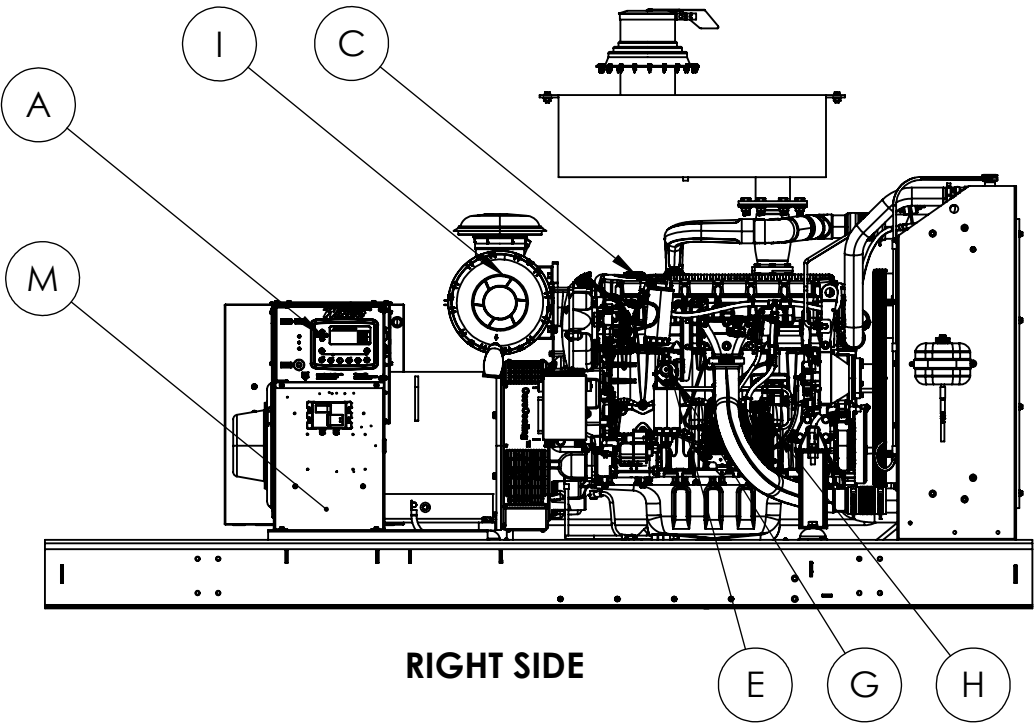
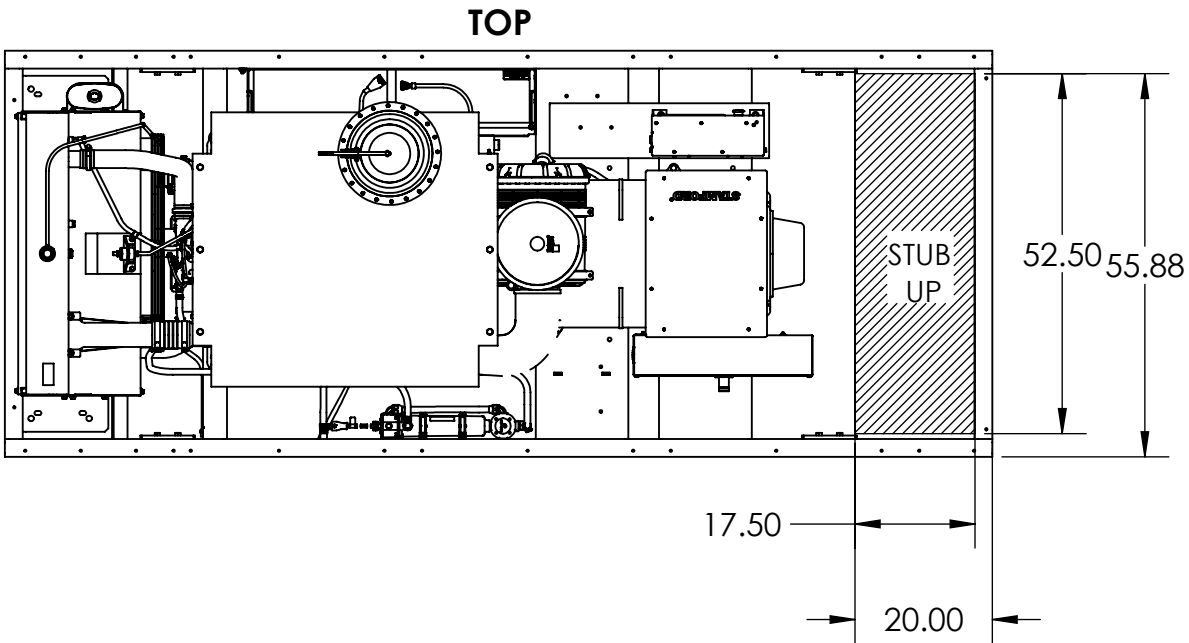

THIS DRAWING CONTAINS PROPRIETARY INFORMATION BELONGING TO WINCO. UNAUTHORIZED USE IS PROHIBITED	TOLERANCE:	+/- 0.0625 DECIMAL +/- 1 DEG ANGULAR	TITLE: OUTLINE DRAWING, DR250F4-XX_2 AND DR300F4-XX_2
	WEIGHT:	LBS	
	MODEL:	DR250_DR300	
	ALL DIMENSIONS INCH ALL WEIGHT POUNDS		PART: 0-590 2 of 2

3/8 FUEL HOSE

