

000-001Z6

AXLE INSTALLED  
UNDER TRAILER DECK

MODEL	USE HOLE
25PTOC	D
75PTOC	E
50PTOC	F
35&45PTOC	G

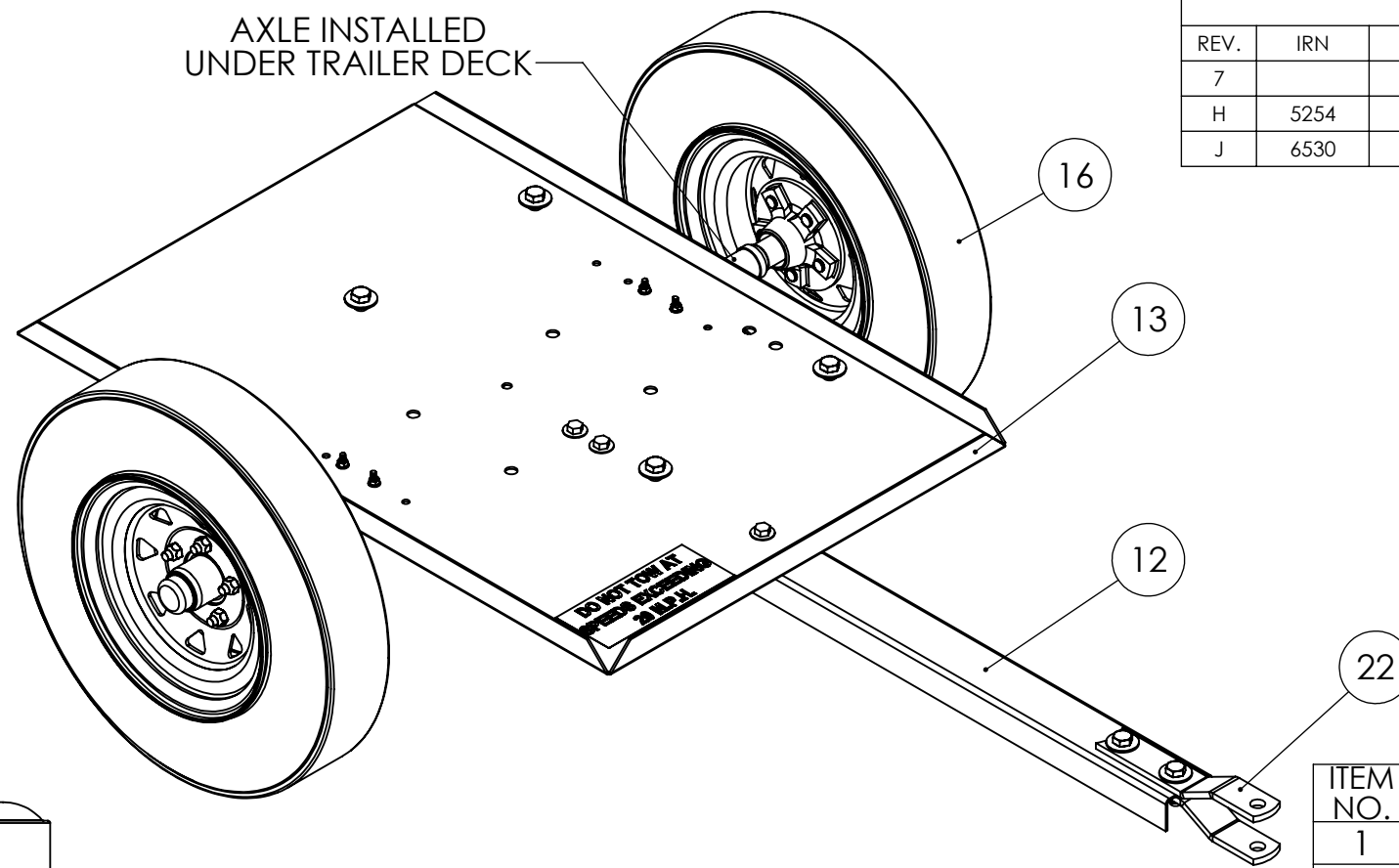

USE FOR MOUNTING  
AXLE WITH ALL  
OTHER LOCATIONS

USE FOR MOUNTING  
AXLE WITH  
"D" HOLE LOCATION

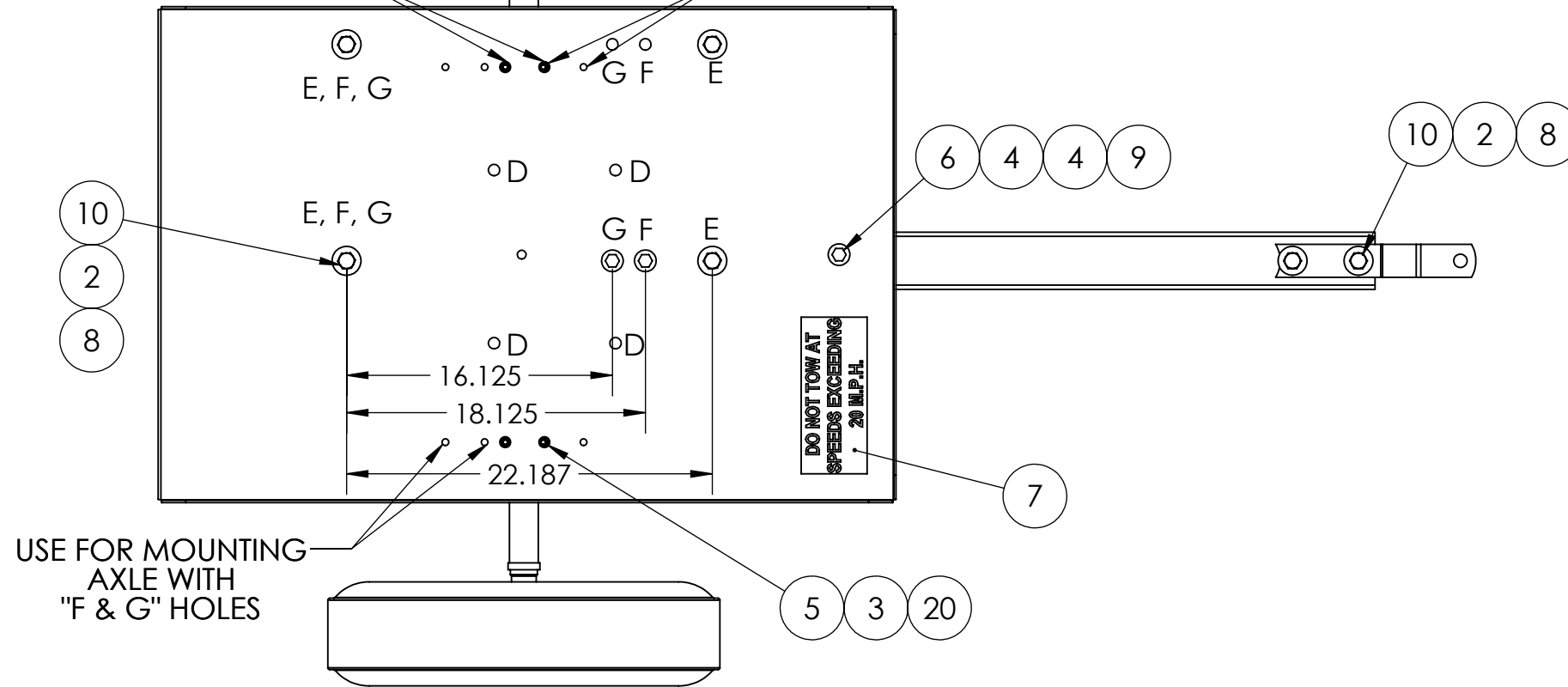

USE FOR MOUNTING  
AXLE WITH  
"F & G" HOLES

REVISIONS					
REV.	IRN	DESCRIPTION	DATE	BY	APP'D
7		REVERTED 16 TO 6 FROM 4	7/1/2013	MK	
H	5254	ADDED VIEW FOR CLARITY OF DECAL PLACEMENT	5/2/2016	SJM	ZJF
J	6530	REPLACED BS6 WITH 91372-000	1/9/2017	SJM	DRC

ITEM NO.	PartNo	DESCRIPTION	QTY.
1	91372-000	BAG, 9"x12", RECLOSABLE, S-1299	1
2	515-000	* FLAT WASHER 5/8 X 1.75	6
3	526-000	* WASHER .3125 ID	4
4	21867-000	* FLAT WASHER	6
5	47136-000	* HEX NUT .3125-18 NYLOK	4
6	57580-000	* 1/2-13 X 1.5 HHB	3
7	64006-000	DECAL-PTO TRAILER	1
8	91083-004	* .625-11X2 HHCS GR5	6
9	92242-000	* NUT HEX .500-13 NYLOCK	3
10	95468-000	* .625-11 NYLOCK	6
11	97100-101	* INSTRUCTION SHEET (SEE NOTE 2)	1
12	97101-000	TONGUE EXTENSION BAR	1
13	97102-000	PTO TRAILER BASE PAN	1
14	97103-000	PARTS BAG (SEE NOTE 1)	1
15	97104-000	AXLE ASSEMBLY 2000LB	1
16	97105-000	13IN TIRE & RIM	2
17	100047-706	CARTON (NOT SHOWN)	1
18	100047-711	CARTON TOP (NOT SHOWN)	1
19	100054-649	CARTON TOP PAD (NOT SHOWN)	1
20	252003010	* U-BOLT 5/16 X 1.5 PLATED	2
21	252003060	* LUG NUT 1/2-20 HEX	10
22	252101030	TONGUE, END	2

NOTES:

- BAG OF PARTS CONTAINS ALL PARTS WITH AN ASTERISK (\*)
- SECURE PTO TRAILER USING FOUR 91083-004, 95468-000, AND 515-000

<p>THIS DRAWING CONTAINS PROPRIETARY INFORMATION BELONGING TO WINCO. UNAUTHORIZED USE IS PROHIBITED.</p> <p>ALL DIMENSIONS INCH</p>	DRAWN BY	DATE	CHK'D BY	DATE	ENG APPR.	DATE
	MTH	3/1/2005			MTH	3/24/05
	TOLERANCE:	+/- 0.0625 DECIMAL		TITLE:		
	MODEL:	+/- 1 DEG ANGULAR		PTO TRAILER ASSEMBLY		
PART: 97100-000						