

REQUIRED TOOLS:

WRENCH SIZES:

- 1/2 INCH
- 5/8 INCH
- 7/8 INCH

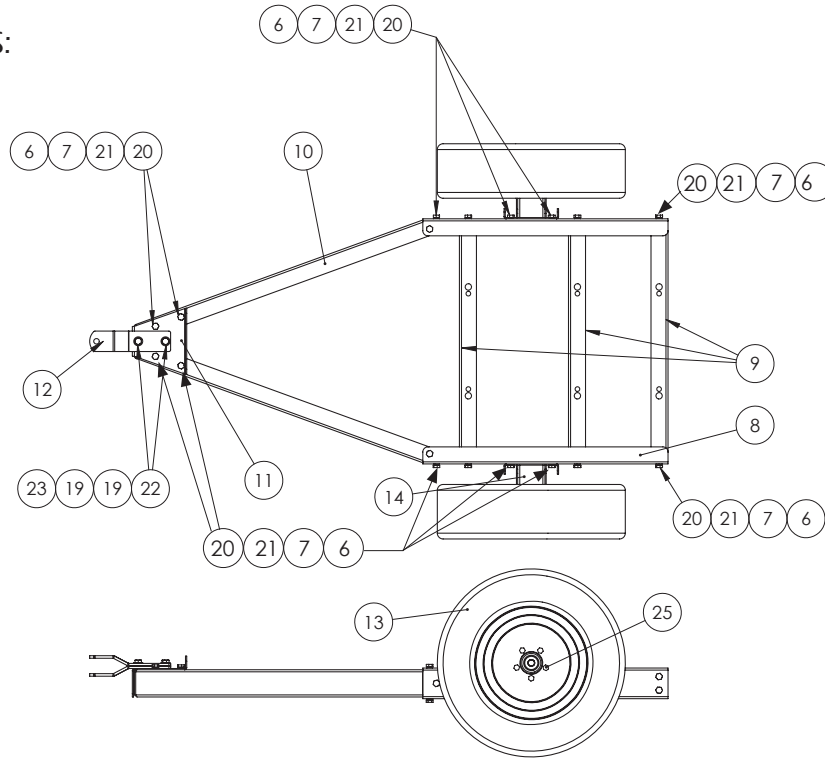

REF. #	PART #	DESCRIPTION	QTY.	QTY IN PARTS BAG
6*	1744-000	Nut, Hex 1/2-13	30	14
7*	21867-001	Flat Washer .51 x .88 x .05	60	28
8	300120-3	Trailer Side	2	
9	300121	Trailer Crossmember	3	
10	300122-3	Trailer Tongue	2	
11	300123-001	Gusset, Tongue	1	
12	300131	Tongue End	2	
13	300133	Ag Rim and Tire, 15 x 5	2	
14	300171	Hub Assembly	2	
15*	350019-1	HHCS 7/8-9 x 2.5 GR5	4	4
16*	350020	.875 SLW	4	4
17*	350021	.875-9 Hex Nut	4	4
18*	351300-1	.875 Washer	4	4
19*	516-000	Flat Washer 5/8 I.D. 1.31 O.D. Steel Zinc	8	4
20*	57580-000	HHCS 1/2-13 x 1.5 GR5	30	14
21*	636-000	Lockwasher 1/2 Split	30	14
22*	91083-004	.625-11 x 2 HHCS GR5	6	4
23*	95468-000	.625-11 Nylock	6	4
25	300134-002	Bolt, Wheel	10	10

NOTE: * Items are in parts bag 100047-122

PARTS BAG

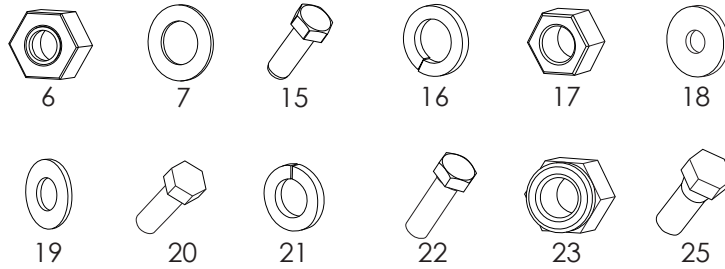

REF. #	PART #	DESCRIPTION	QTY.	QTY IN PARTS BAG
6*	1744-000	Nut, Hex 1/2-13	30	14
7*	21867-001	Flat Washer .51 x .88 x .05	60	28
15*	350019-1	HHCS 7/8-9 x 2.5 GR5	4	4
16*	350020	.875 SLW	4	4
17*	350021	.875-9 Hex Nut	4	4
18*	351300-1	.875 Washer	4	4
19*	516-000	Flat Washer 5/8 I.D. 1.31 O.D. Steel Zinc	8	4
20*	57580-000	HHCS 1/2-13 x 1.5 GR5	30	14
21*	636-000	Lockwasher 1/2 Split	30	14
22*	91083-004	.625-11 x 2 HHCS GR5	6	4
23*	95468-000	.625-11 Nylock	6	4
25*	300134-002	Bolt, Wheel	10	10

STEP 1

- The base is shipped pre-assembled. Depending on your model of PTO generator, the middle cross member (9) may need to be re-installed according to the drawing below.
- Bolt the cross members to the trailer sides (8) using hardware (21,20,7,6).

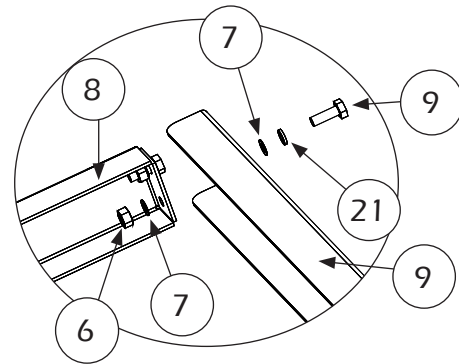

W100PTO, W105PTO
W120PTO, W145PTO
W150PTO, W165PTO

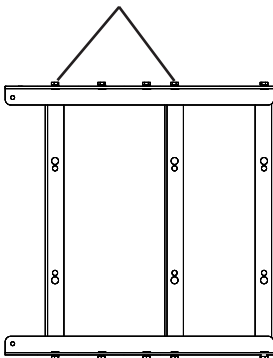

W70PTO, W75PTO
W85PTO

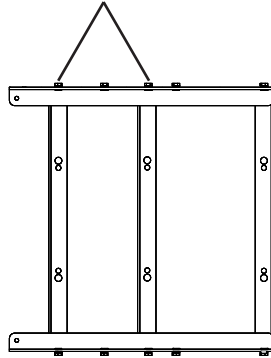

Note: The crossmember will use the same holes as the support axle for the W70 thru W85 PTOs.

STEP 2

- Bolt the trailer sides (9) to the trailer tongues (10) using hardware (21,20,7,6).
- The pre-assembled gusset tongue may need to be loosened for alignment.

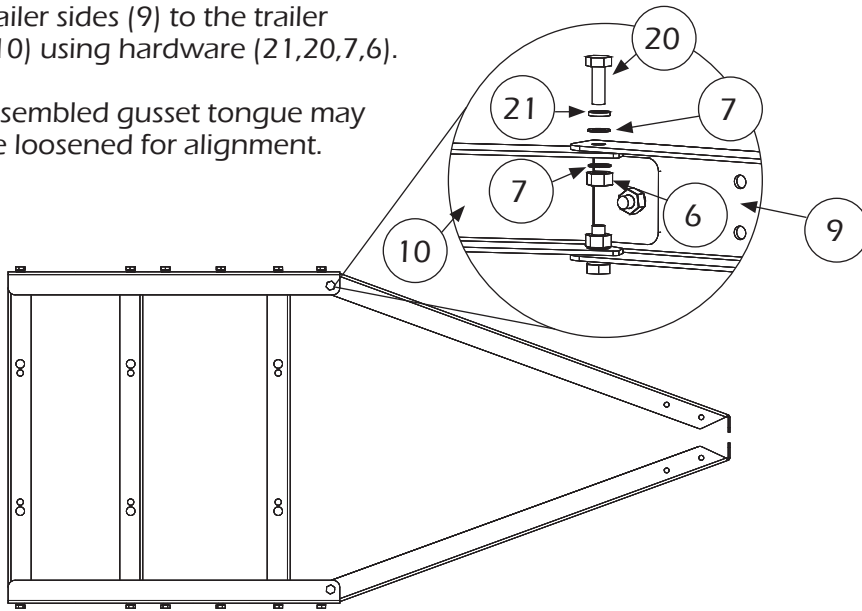

STEP 3

- Attach the hub assemblies (14) to the trailer sides (8) using hardware (21, 20, 7, 6).

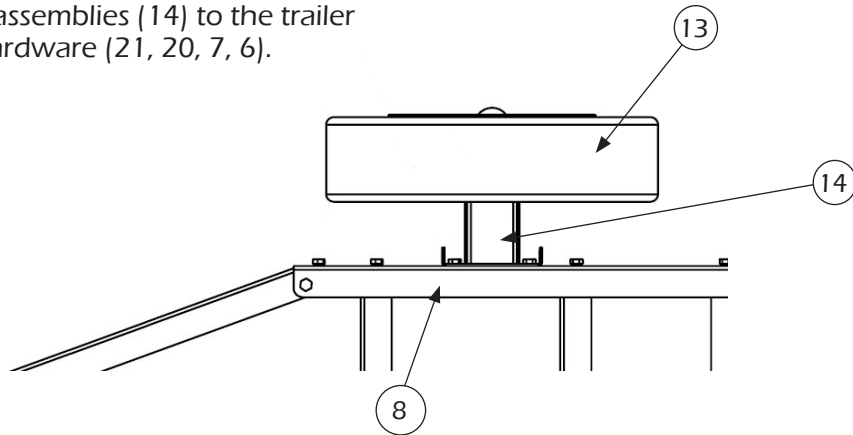

- Attach the wheel and rim (13) to the hub assembly (14) using hardware (25).

