

WARNING: REFILL OIL AND CHECK OIL LEVEL BEFORE STARTING GENERATOR AFTER INSTALL.

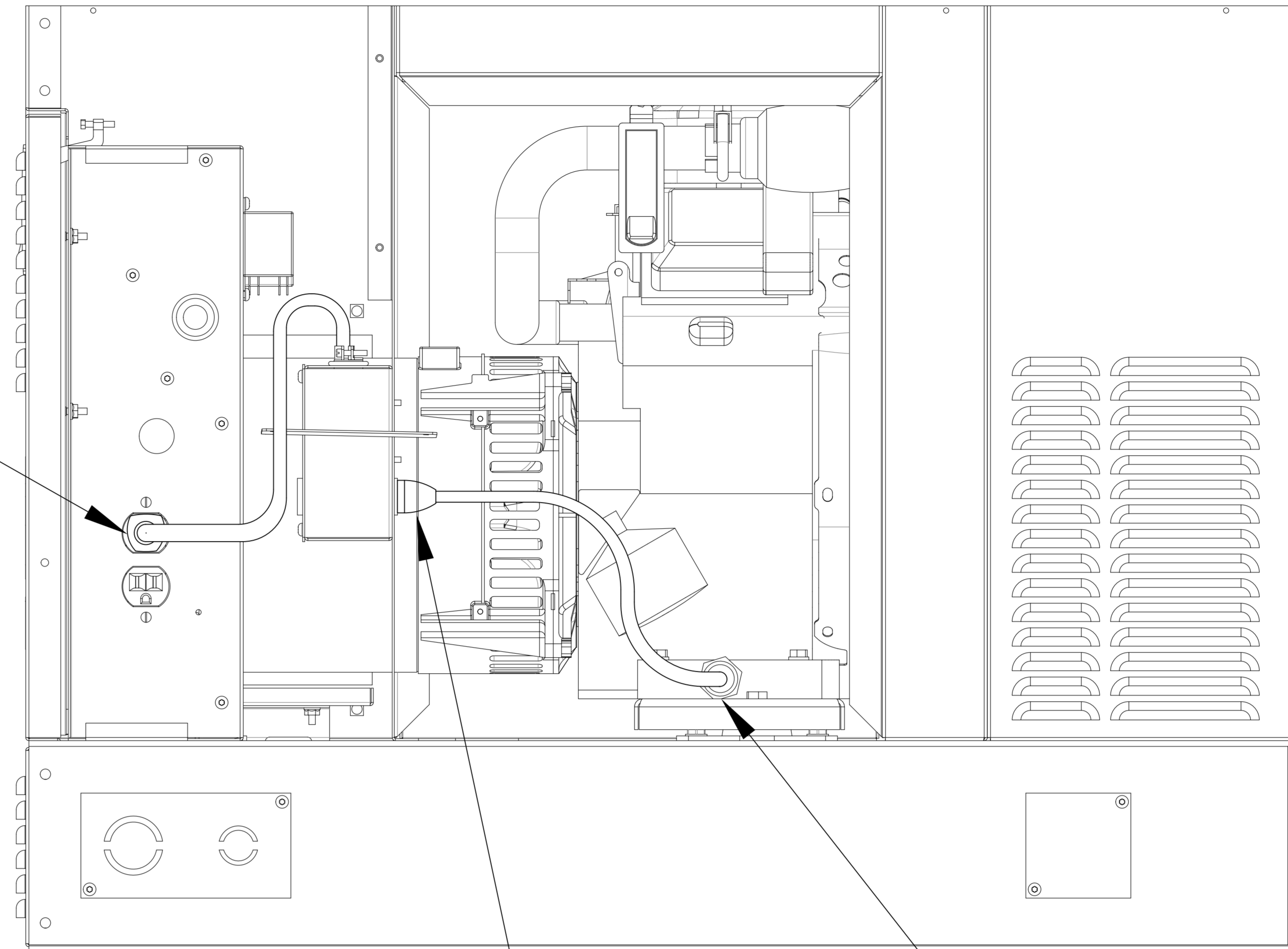

3) PLUG IN THE HEATER CONTROL UNIT INTO THE RECEPTACLE LOCATED ON THE LOWER SIDE OF THE CONTROL TOWER.

2) INSTALL THE HEATER CONTROL UNIT THROUGH THE REAR DOOR, SECURING IT USING THE SCREWS FROM THE COVER PLATE.

6) PLUG THE OIL HEATER CORD INTO THE HEATER CONTROL UNIT RECEPTACLE.

4) MOVE TEE FITTING ASSEMBLY TO THE OTHER SIDE OF ENGINE.

5) INSTALL THE OIL HEATER UNIT IN THE RIGHT SIDE OIL PLUG HOLE AS SHOWN.

1) OPEN THE SIDE DOOR AND REMOVE THE COVER PLATE FROM THE DIVIDER PANEL.

* WILL REUSE SCREWS FOR HEATER CONTROL UNIT

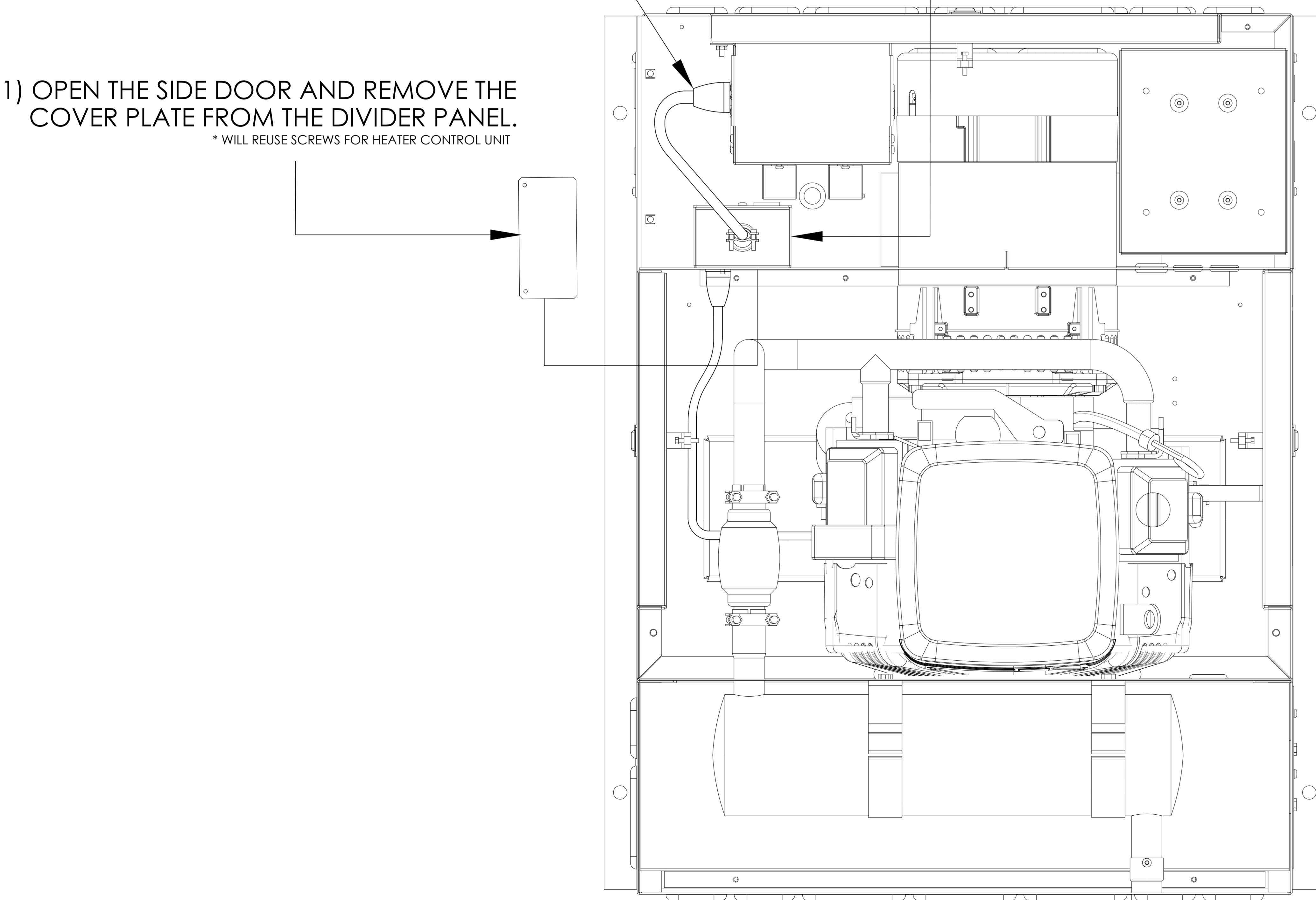

UNLESS OTHERWISE SPECIFIED				MACHINED SURFACE TEXTURE		ALL DIMENSIONS GIVEN IN INCHES WORK TO DIMENSIONS FLAT OUTSIDE VIEW SHOWN UNLESS NOTED -DO NOT SCALE-	
FRACTIONS		ANGULAR					
1 PLACE DEC.	.1		1.5				
2 PLACE DEC.	.015						
3 PLACE DEC.	.005						
	DRAWN BY	DATE	CHK'D BY	DATE	ENG APPR.	DATE	SCALE
	MVW	11/22/11			CLR	11/30/11	
THIS DRAWING CONTAINS PROPRIETARY INFORMATION BELONGING TO WINCO. UNAUTHORIZED USE IS PROHIBITED	MATERIAL:						
	FINISH:						
	ASSY:						
	MODEL:	ULPSS8B4W					
	TITLE:			PSS8 OIL HEATER INSTRUCTION SHEET			
	PART NO.			300484-204			REV. A