

Wiring Diagram C55373
 Schematic N/A
 Generator Parts
 Unassembled C55373
 Complete Unit
 Part # C58285

 REPAIR
 PARTS LIST
 #552

Size 3000 Watts
 Drive Direct
 Type Four Pole
 Unit Model # P3BS-3E/B

<u>DESCRIPTION</u>	<u>PART #</u>	<u>QTY</u>
Armature	55319-1	1
Armature Bearing	55223	1
Armature Thru Bolt	23197-7	1
Fan Assy.	55101	1
Fan Washer	23558	1
Fan Lockwasher	55224	1
Fan Nut	23605	1
Field Coil	55372	1
Field Coil	55372-1	1
Field Coil	55372-2	1
Field Coil	55372-3	1
Shell & Bracket Assy.	55370	1
Pole Shoe	40091	4
Pole Shoe Retainer	40092	4
Engine Adaptor Bracket	54025	1
Adaptor Bracket Screw	54028	4
End Cover Assy.	55368	1
End Cover Receptacle	55636	2
End Cover Receptacle	55235	1
Start Switch	2210	1
Brush Rack Assy.	55369	1
(Complete)	& -1	1
A.C. Brush	23607	6
A.C. Brush Holder	23500	6
D.C. Brush	41393	4
D.C. Brush Holder & Plate Assy.	55376	2
A.C. Condenser	41221	2
D.C. Condenser	41180	1
Resistor (Charge)	55377	1
Cradle	57906	1
Sub Base	23754	1
Shock Mounts	20191	8

ENGINE MAKE Briggs & Stratton MODEL # 243431 PART # 53884

LEAD CONNECT TO
R. TERM. OF STRAP
WITH

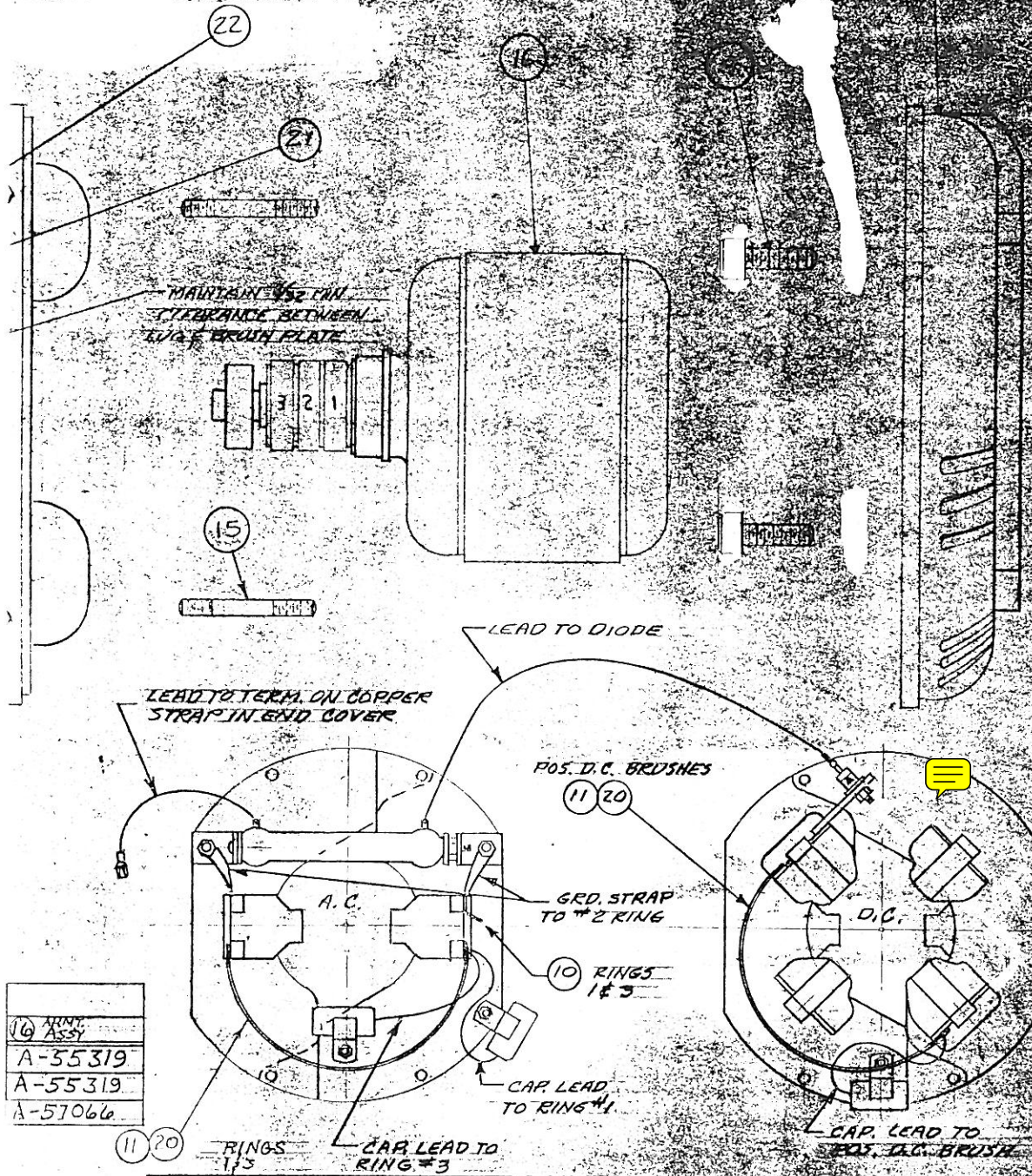

16	ARMG Assy
A-55319	
A-55319	
A-57066	

ALL DIMENSIONS GIVEN IN INCHES - WORK TO DIMENSIONS - DO NOT SCALE			
TOLERANCES (UNLESS OTHERWISE SPECIFIED): FRACTIONS ± 1/16 DECIMALS ± .005 PUNCHED HOLES ± .004 ± .000			
DRAWN BY	DATE	CHECKED BY	DATE
TJK	8-19-70	MMW	9-4-70
REVISED			
4	ADDED - 1 NO C/N	11-17-78	MMW
3	ADDED - 1	12-10-77	MMW
GENERATOR PART		WINCHARGER CORP. C-5537-	
CLOUD CITY, IOWA			

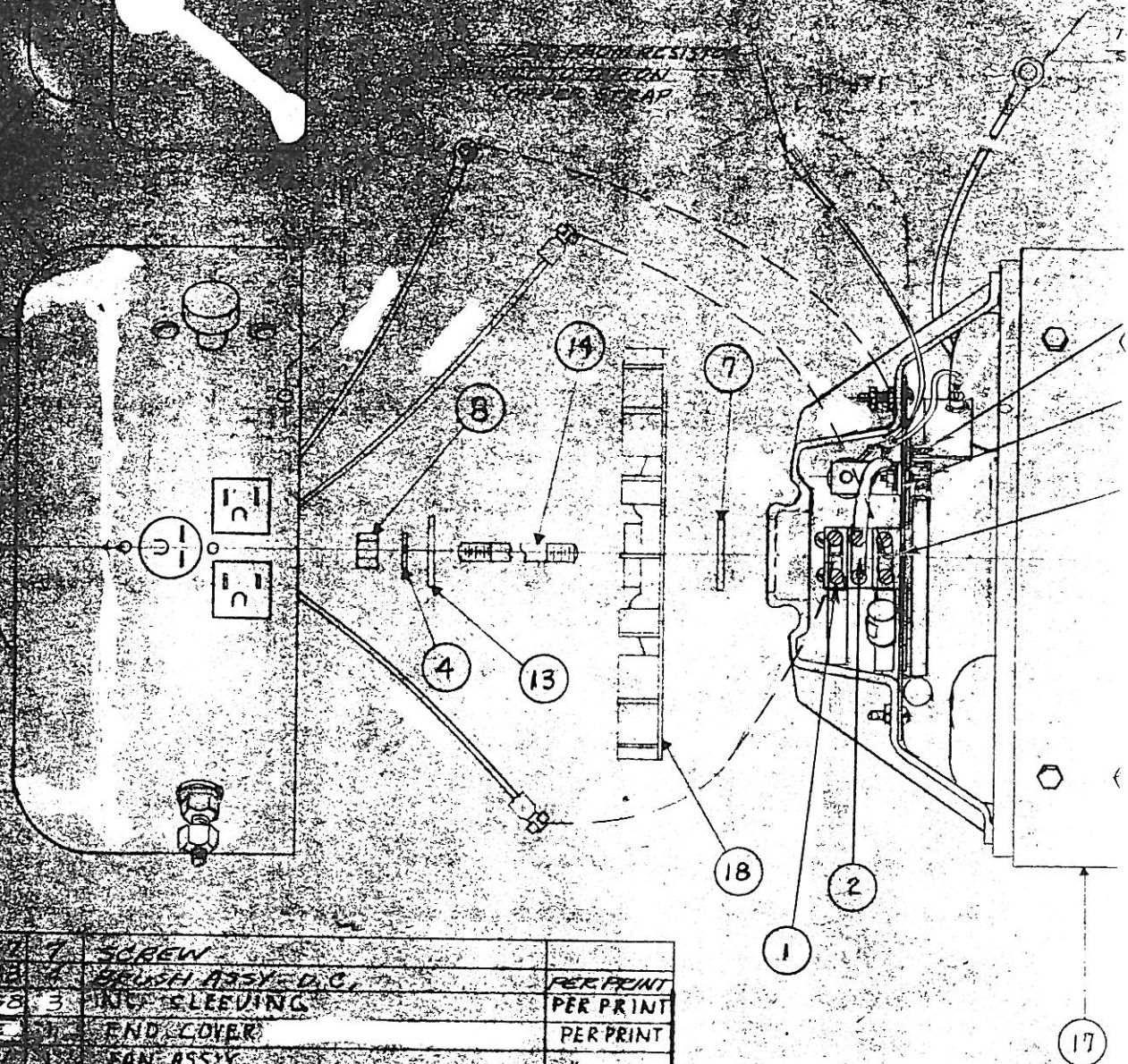

	7	SCREW	
	8	BRUSH ASSY. D.C.	PER PRINT
	3	INS. SLEEVING	PER PRINT
SEE TABLE	1	END COVER	PER PRINT
	1	FAN ASSY.	" "
SEE TABLE	1	FIELD SHELL & COIL ASSY.	" "
SEE TABLE	1	ARMATURE ASSY.	" "
	4	STUD	" "
	11	SPECIAL STUD	" "
	3	FLAT WASHER	" "
C-24211-7	1	END BRACKET	" "
	3	GROUND STRAP	" "
	2	TERMINAL	PER PRINT
23604	2	HEX. SOC. CAP. SCR. STL.	
	1	HEX. NUT STL. CAD.	5/16-24
224	1	LOCK WASHER INT. FECT.	1/16
	2	SLOTTED HEX. HD. SELF-TAPPING SCR. TYPE 'F'	PER PRINT
	4	HEX. NUT STL. CAD.	5/16-18
	5	SPLIT TYPE LOCK WASHER STL. CAD.	5/16 STD.
A-23604	6	BRUSH ASSY.	PER PRINT
40746	12	MACH. SCR. RD. HD.	" "

TABLE		
ASSY.	(17) SHELL & COIL	(18) COVER ASSY.
C-55373	C-55371	C-55368
C-55373-1	C-55371-1	A-55007
C-55373-2	C-55371	C-55368