

### ILLUSTRATED PARTS LIST

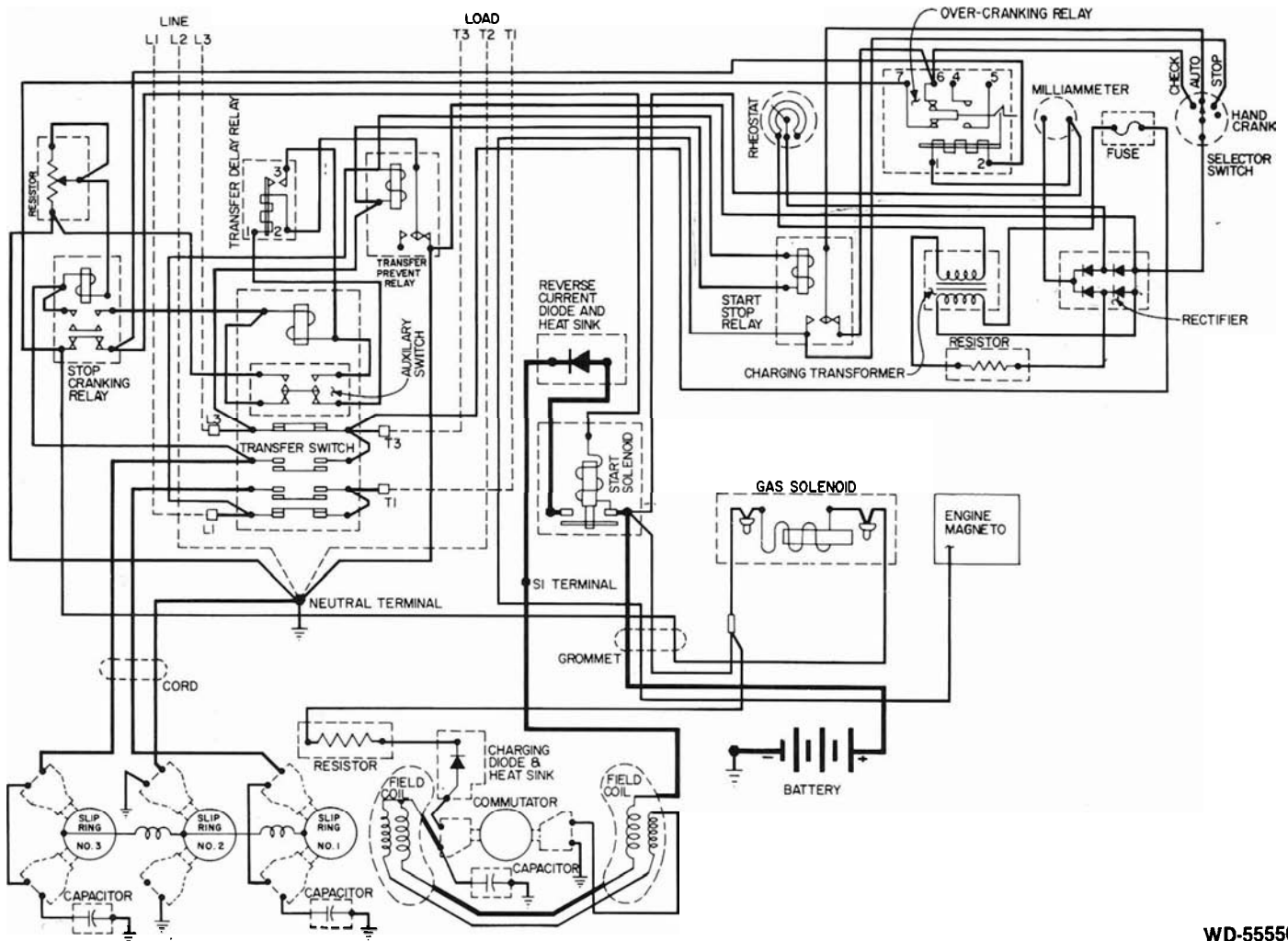

WD-55550

### SCHEMATIC DIAGRAM

This IPL contains wiring, illustration, parts list, ordering information and technical data to perform routine maintenance on this generator. Consult factory with model no., serial no. and test data for further assistance.

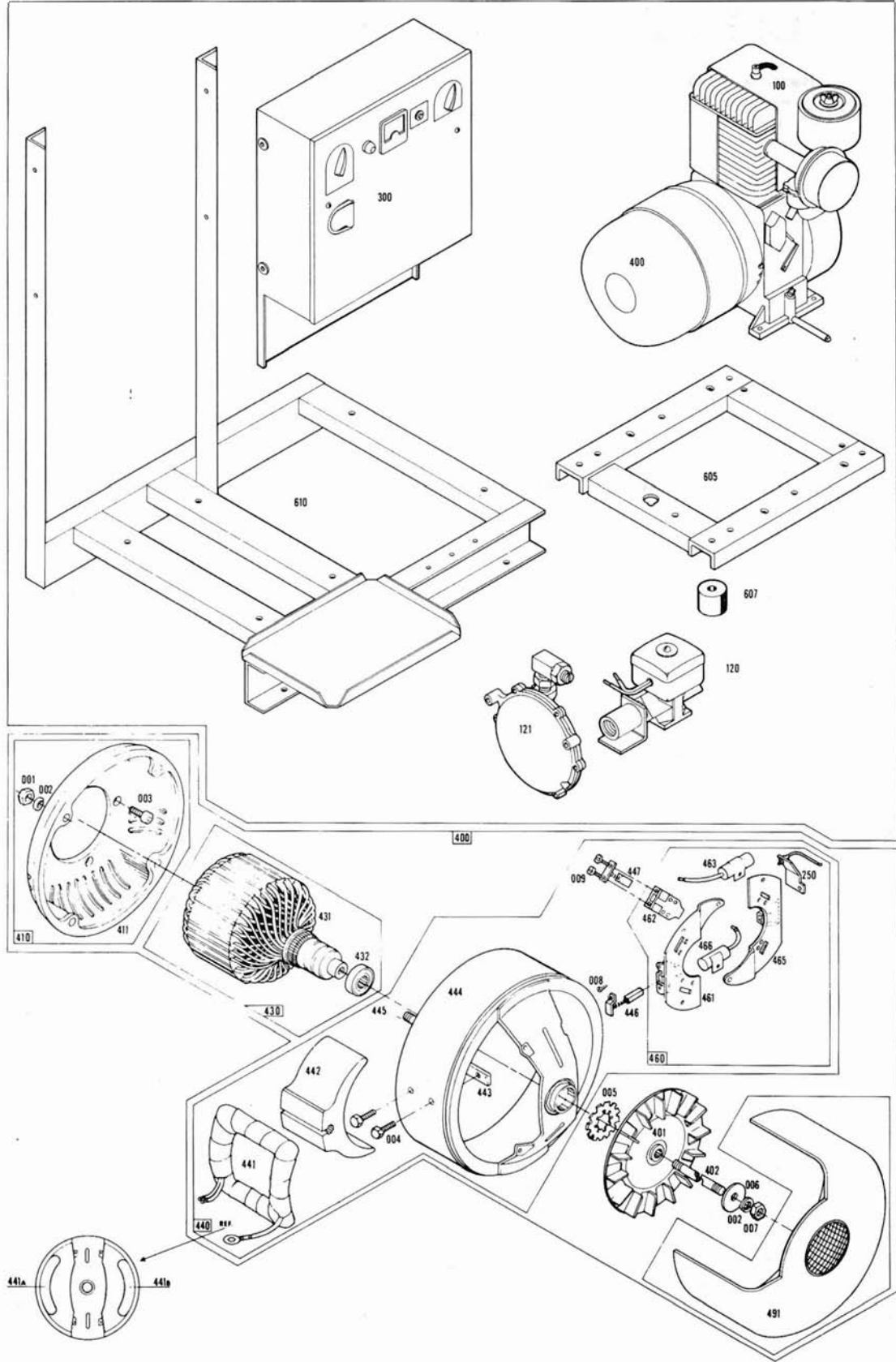

REF. NO.	DESCRIPTION	QTY.	PART NO.	REF. NO.	DESCRIPTION	QTY.	PART NO.
000	Hardware						
001	Hex Nut 5/16-18	4	458	432	Bearing	1	50215
002	Lockwasher Split 5/16	5	480	440	Field Shell & Coil	1	57724-1
003	Screw Allenhead 7/16-14 x 7/8	4	23604	441A	Field Coil	1	59146
				441B	Field Coil	1	59146-1
004	Cap Screw 3/8-16 x 1 3/4	6	399	442	Pole Shoe	2	42882
005	Lockwasher 11/16 Int. Tooth	1	40552	443	Pole Shoe Retainer	2	51697
				444	Field Shell and Bracket	1	57678
006	Flatwasher 11/32 ID	1	23558	445	Stud	4	51434
007	Hex Nut 5/15-24	1	23605	446	Brush DC	2	47683
008	Machine Screw 10-24 x 3/8	4	4637	447	Brush AC	9	55536
009	Machine Screw 8-32 x 5/16	18	40746	460	Brush Rack Assembly	1	52374
				250	Heat Sink and Diode Ass'y.	1	54732
100	Drive B & S 326431-0346-01	1	59244	461	Riveted Brush Rack Ass'y.	1	47684
				462	Brush Holder	9	23500
120	Solenoid (Fuel shut off)	1	42942	463	Capacitor AC	2	41221
121	Regulator (Secondary)	1	55559	465	Riveted Brush Rack Ass'y.	1	47684-1
123	Load Block	1	55560	466	Capacitor DC	1	41180
				491	End Cover	1	55438
400	Generator Assembly	1	57723-1				
401	Fan Assembly	1	23404	605	Subframe Assembly	1	57677
402	Special Shaft	1	23192-12	607	Shock Mount	4	23623
411	End Bracket	1	55493	610	Main Frame	1	58977
430	Armature Assembly	1	57628	—	Flexible Exhaust Line	1	24140-2
431	Armature	1	57628-1		(not shown)		

**PARTS ORDERING INFORMATION REQUIRED**



To fill your order for service parts, please advise the complete Generator model number and serial number, part number(s), and part description. If in doubt, consult the factory prior to placing the order. Send all parts orders to WINCO, Division of Dyna Technology, Inc., 225 South Cordova Ave., Le Center, MN 56057.

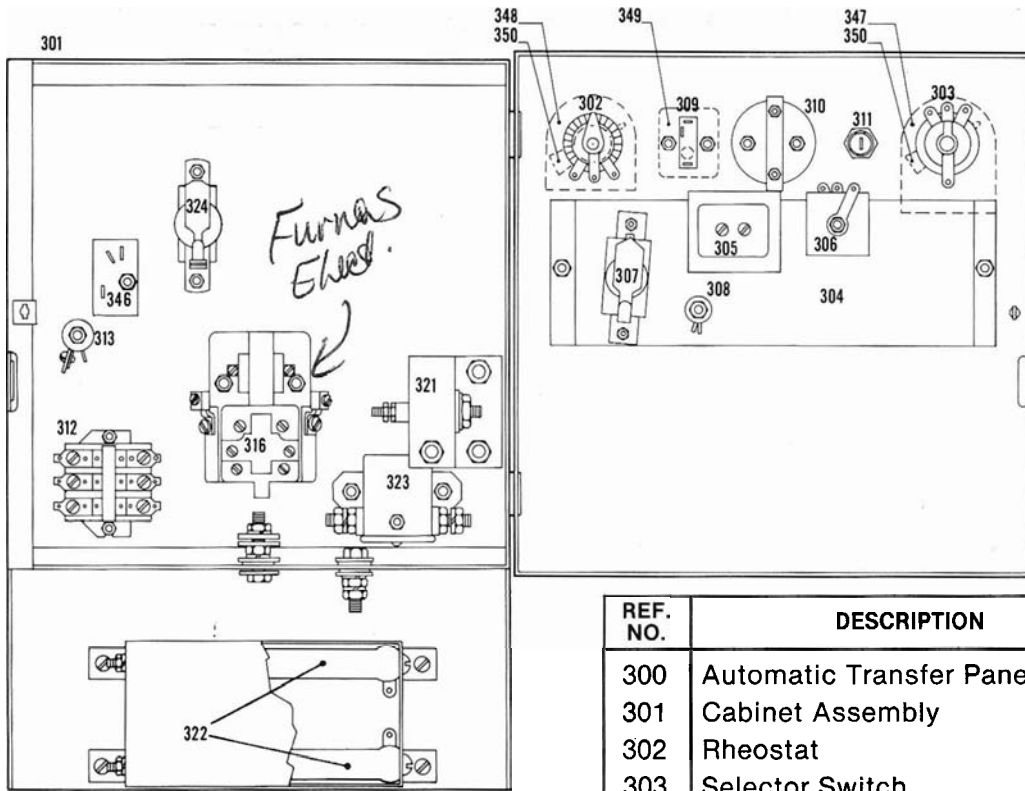

1-59252

REF. NO.	DESCRIPTION	QTY.	PART NO.
300	Automatic Transfer Panel	1	59252
301	Cabinet Assembly	1	59235
302	Rheostat	1	24786
303	Selector Switch	1	57946
304	Mounting Bracket	1	59240
305	Transformer	1	46755
306	Rectifier <i>91452</i>	1	<del>22191</del>
307	Relay (start/stop)	1	40518
308	Resistor	1	24787
309	Relay (over cranking)	1	48585
310	Milliammeter	1	22188
311	Fuse Holder	1	2489
311A	Fuse 250V 1A 3AG	1	22219
312	Relay (stop cranking)	1	92065
313	Resistor	1	23635
316	Contactor Switch	1	46125
321	Heat Sink and Rectifier <i>Rect 51040</i>	1	55428
322	Resistor	2	54599
323	Start Solenoid	1	24061
324	Relay (transfer prevent)	1	40518
346	Thermal Delay Relay	1	48525
347	Selector Switch Dial Plate	1	21962
348	Rheostat Dial Plate	1	8777
349	Instruction Plate	1	53324
350	Knob	2	8778
—	Auxiliary Contact Kit (not shown)	1	46759

## TECHNICAL DATA

### GENERATOR SPECIFICATIONS:

Watts—7000 Volts—115/230 Amps.—30  
PH-1; Hz-60; RPM—3600

**Nominal Voltage: No Load: Full Load:**  
115/230 Volts A.C. 132/264 Volts A.C. 112/224 Volts A.C.

### Resistance:

Field Coils— $5.4 \pm .3$  ohms  
Armature—Less than 1 ohm ring to ring

### Excitation Voltage:

Approximately 46 Volts D.C.

### Separately Excited:

12 VDC to the Positive Field Lead  
50 to 70 VAC Output

Start Delay Relay # 54313-4  
Assy # 58836-0  
Enclosure # 58492-0  
Mounting Plate # 58498-C

# WINCO®

Division of  
**DYNA TECHNOLOGY, INC.**  
225 South Cordova  
Le Center, MN 56057  
Phone (612) 357-6821  
Telex 290753