

WINCO GENERATOR PLANT
 MODELS P105TH-1M/A and P109BH-1M/A

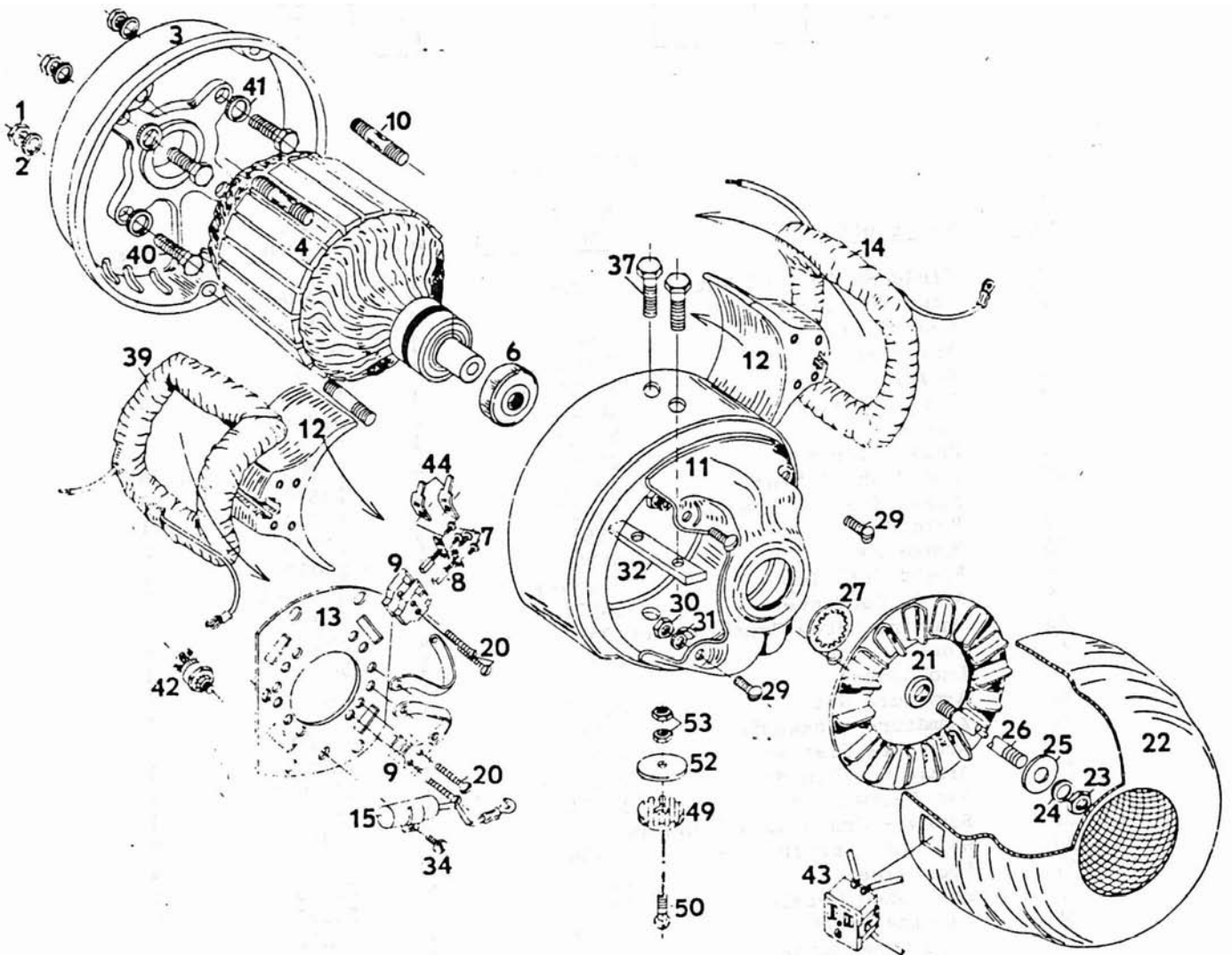

Manufactured by

WINCO

Division of Dyna Technology, Inc.

225 South Cordova St. / LE CENTER, MINNESOTA 56057

Phone: (612) 357-6821

RPL#611

FEB78

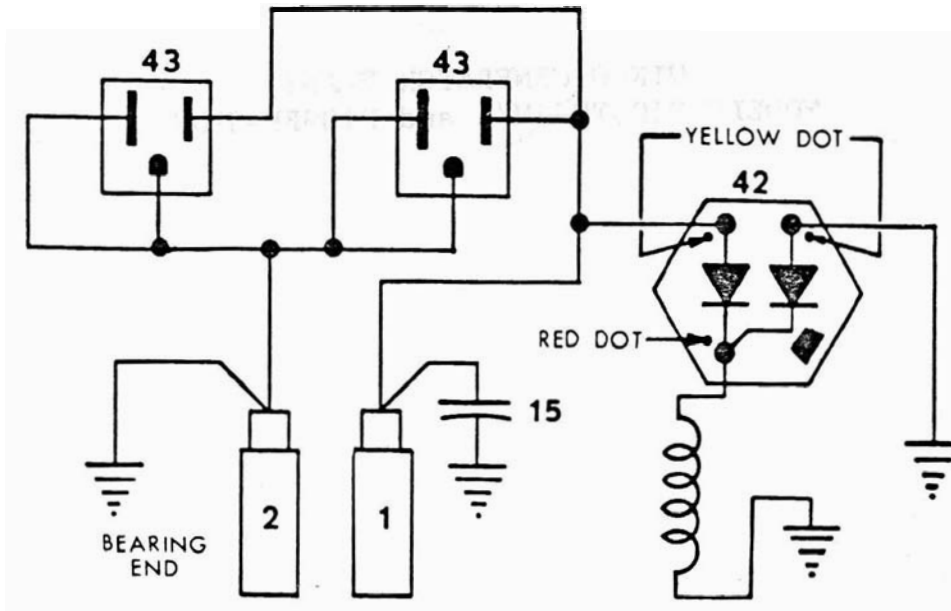

PARTS LIST

Ref. No.	Description	Model P105TH-1M/A	Qty.	Model P109BH-1M/A	Qty.
1	Field Shell Stud Nut	638	3	638	3
2	Stud Nut Lockwasher	479	3	479	3
3	End Bracket	55043	1	43887	1
4	Armature	55090-1	1	55275-1	1
6	Bearing	55223	1	55223	1
7	Screw - Brush	40746	8	40746	8
8	Brush	23607	4	23607	4
9	Brush Holder	23500	4	23500	4
10	Field Shell Stud	23817	3	23817	3
11	Field Shell & Bracket	53627	1	53580	1
12	Pole Shoe	23804	2	23806	2
13	Brush Rack	55091	1	55091	1
14	Field Coil Top	55284-1	1	53639-1	1
15	A. C. Condenser	54977	1	54977	1
20	Machine Screw Brush Holder	23598	4	23598	4
21	Fan	54976	1	54976	1
22	End Cover	55304	1	55304	1
23	Armature Nut	23605	1	23605	1
24	Armature Lockwasher	480	5	480	5
25	Armature Flat Washer	23558	1	23558	1
26	Armature Thru Bolt	23197-4	1	23197-5	1
27	Fan Lockwasher	55224	1	55224	1
29	Screw - Brush Rack Mounting	420	3	420	3
30	Hex Nut - Brush Rack	456	4	456	4
31	Lockwasher	22423	4	22423	4
32	Pole Shoe Retainer	53629	2	53577	2
34	Machine Screw	6402	1	6402	1
37	Pole Shoe Screw	1743	2	1743	2
39	Field Coil Bottom	55284	1	53639	1
40	Cap Screw	55576	4	55576	4
41	Lockwasher	480	5	480	5
42	Rectifier	54976	1	54976	1
43	Receptacle	53636	2	53636	2
44	Terminal Connector	53643	1	53643	1
49	Spring Mount	55096	4	55096	4
50	Machine Screw	42482	4	42482	4
52	Lock Washer	480	6	480	6
53	Hex Nut	458	6	458	6

Any parts required for gas engine portion of the unit should be obtained from the local engine manufacturer's service station.