

**WINCO GENERATOR PLANT
MODELS P102BH-1M, P107BH-1M and P205BH-1M**

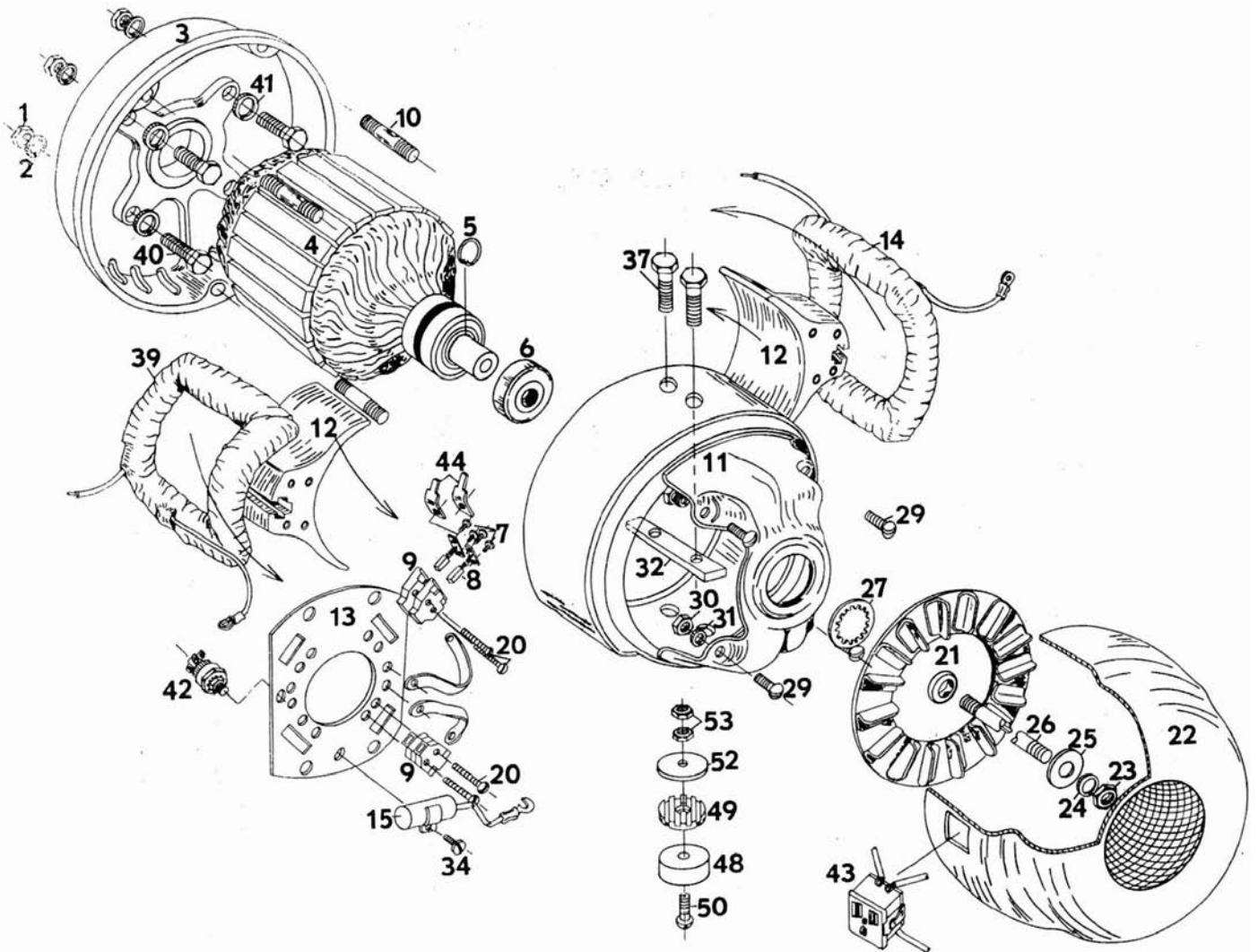

P102, 107, 205 BH M

Manufactured by



Division of Dyna Technology, Inc.

East Seventh at Division / P. O. Box 3263 / Phone (712) 252-1821 / SIOUX CITY, IOWA 51102

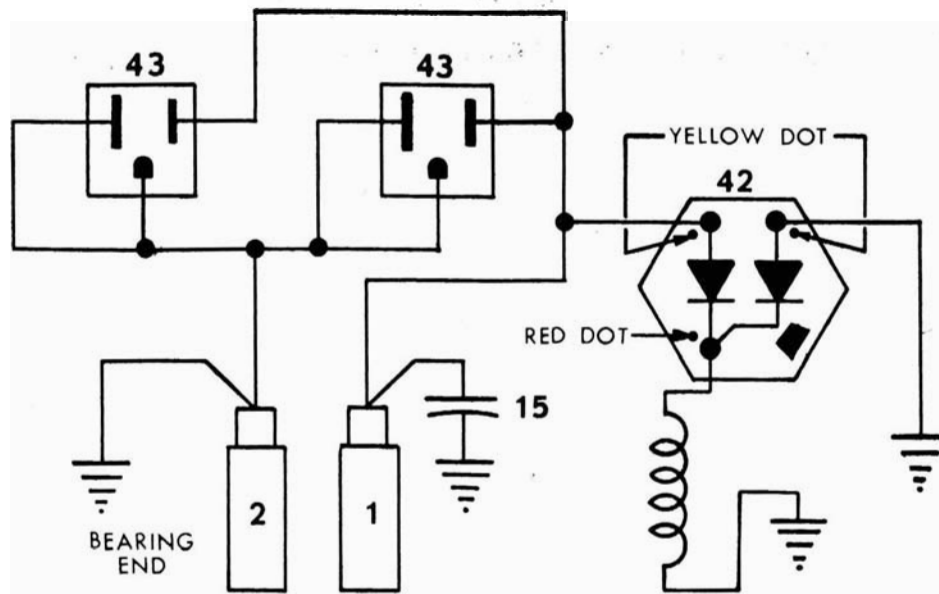

PARTS LIST

Ref. No.	Description	Model P102BH-1M/A Qty.		Model P107BH-1M/A Qty.		Model P205BH-1M/A Qty.	
1	Field Shell Stud Nut (1/4 - 20)	638	3	638	3	638	3
2	Stud Nut Lockwasher (1/4")	479	3	479	3	479	3
3	End Bracket	43887	1	43887	1	43887	1
4	Armature	53628-1	1	53579-1	1	53617-1	1
5	Bearing Retaining Ring	23568	1	23568	1	23568	1
6	Bearing	46911	1	46911	1	46911	1
7	Screw - Brush (#8-32x5/16")	40746	4	40746	8	40746	8
8	Brush	23607	2	23607	4	23607	4
9	Brush Holder	23500	2	23500	4	23500	4
10	Field Shell Stud	23817	3	23817	3	23817	3
11	Field Shell & Bracket	53627	1	53580	1	53614	1
12	Pole Shoe	23804	2	23806	2	53612	2
13	Brush Rack	53698	1	53698	1	53698	1
14	Field Coil Top	53676-1	1	53639-1	1	53615-1	1
15	A. C. Condenser	41221	1	41221	1	41221	1
20	Machine Screw Brush Holder (#8-32x1 5/16")	23598	2	23598	4	23598	4
21	Fan	23727	1	23727	1	23727	1
22	End Cover	53637	1	53637	1	53637	1
23	Armature Nut (5/16 - 24)	23605	1	23605	1	23605	1
24	Armature Lockwasher (5/16")	480	1	480	1	480	1
25	Armature Flat Washer	23558	1	23558	1	23558	1
26	Armature Thru Bolt	23197-6	1	23197-11	1	23197-10	1
27	Fan Lockwasher	40552	1	40552	1	40552	1
29	Screw—Brush Rack Mounting (#10-24x3/4")	420	4	420	4	420	4
30	Hex Nut—Brush Rack (#10-24)	456	4	456	4	456	4
31	Lockwasher (#10)	484	4	484	4	484	4
32	Pole Shoe Retainer	53629	2	53577	2	53613	2
34	Machine Screw (#8-32x3/8")	6402	2	6402	2	6402	2
37	Pole Shoe Screw	1743	2	1743	4	1743	4
39	Field Coil—Bottom	53676	1	53639	1	53615	1
40	Cap Screw (5/16"-24x1 1/8")	53645	4	53645	4	53645	4
41	Lockwasher (5/16")	480	4	480	4	480	4
42	Rectifier	53976	1	53646	1	53646	1
43	Receptacle	53636	2	53636	2	53636	2
44	Terminal Connector	53643	2	53643	2	53643	2
48	Rubber Foot	20191	3	20191	3	20191	3
49	Shock Mount	47509	3	47509	3	47509	3
50	Machine Screw (1/4-20x1 1/2")	639	2	639	2	639	2
52	Flat Washer	2586-2	1	2586-2	1	2586-2	1
53	Hex Nut	638	2	638	2	638	2

Any parts required for gas engine portion of the unit should be obtained from the local engine manufacturer's service station.