

WINCO GENERATOR PLANT MODEL 3WS7D2D-FM22-A

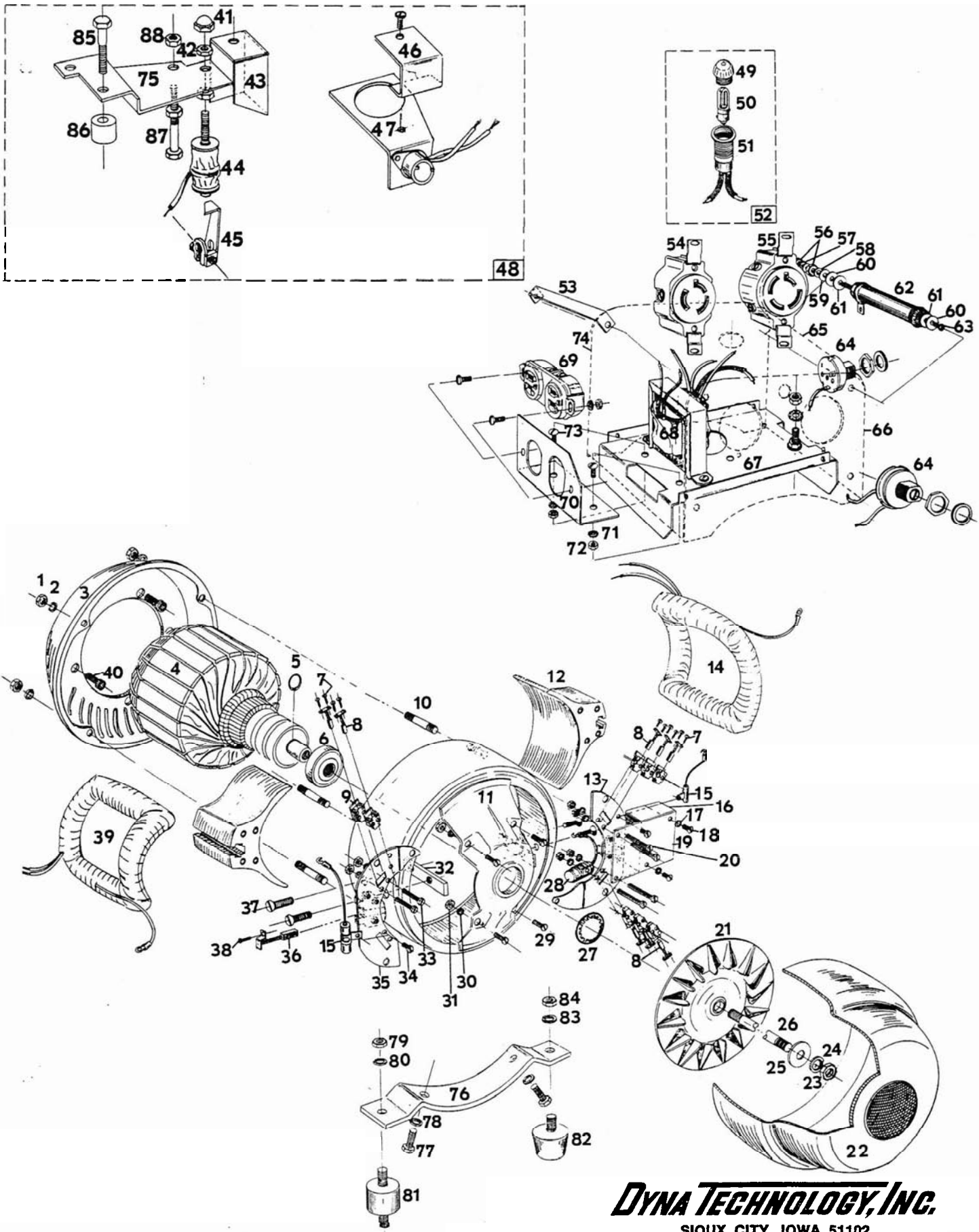

DYNA TECHNOLOGY, INC.
SIOUX CITY, IOWA 51102

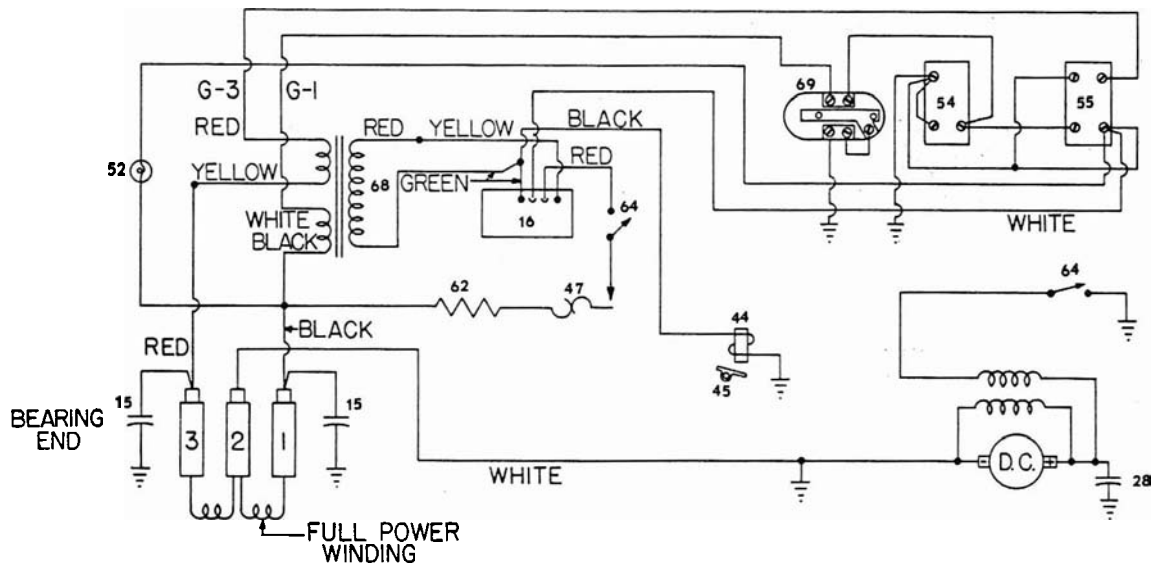

PARTS LIST

Ref No.	Part No.	DESCRIPTION	Quantity	Ref No.	Part No.	DESCRIPTION	Quantity
1	458	Field Shell Stud Nut (5/16-18)	4	41	44948	Acorn Nut (5/16-24)	1
2	480	Stud Nut Lockwasher (5/16")	4	42	44894	Hex Jam Nut (5/16-24)	2
3	23406-1	End Bracket	1	43	44891	Cover	1
4	44360-1	Armature	1	44	44889	Electro Magnet	1
5	23568	Bearing Retaining Ring	1	45	48187	Bracket—Throttle Lever	1
6	4783	Bearing	1	46	45222	Bracket—Cover Thermostat	1
7	40746	Screw—A.C. Brush (#8-32x5/16")	16	47	49417	Thermostat	1
8	23607	A.C. Brush	8	48	49392	Bracket & Magnet Assembly Complete	1
9	23500	Brush Holder—A.C.	8	49	44341-1	Dome Only	1
10	23451	Field Shell Stud	4	50	43358	Bulb	1
11	43327	Field Shell & Bracket	1	51	43341	Socket & Dome	1
12	24851	Pole Shoe	2	52	43340	Socket Assembly	1
13	41744-1	Brush Rack & D.C. Brush Holder	1	53	24087	Brace—Control Box	1
14	44361-1	Field Coil	1	54	22901	Receptacle 115 Volt	1
15	41221	A.C. Condenser	2	55	22902	Receptacle 230 Volt	1
16	48574	Module for Conservator	1	56	456	Hex Nut (#10-24)	2
17	21976	Lockwasher (#8 Ext.)	2	57	21976	Lockwasher #10 Ext.	1
18	6402	Screw (8-32x3/8")	2	58	484	Lockwasher #10	1
19	49507	Bracket—Module	1	59	598	Flatwasher #10	1
20	40550	Machine Screw—Brush Holders (8-32x2")	4	60	266	Fiber Washer	2
21	23404	Fan	1	61	1376	Shoulder Washer	2
22	23634	End Cover	1	62	48583	Resistor	1
23	23605	Armature Nut (5/16-24)	1	63	25394	Thru Bolt	1
24	480	Armature Lockwasher (5/16")	1	64	44022	Switch	2
25	23558	Armature Flat Washer	1	65	45058	Box Cover	1
26	23197	Armature Thru Bolt	1	66	48968	Front Panel	1
27	40552	Fan Lockwasher	1	67	43966	Saddle	1
28	41180	D.C. Condenser	1	68	40450	Transformer	1
29	3728	Screw—Brush Rack Mounting (#10-24x1/2")	4	69	24749	Receptacle 115 Volt Duplex	1
30	484	Lockwasher—Brush Rack Mounting (#10)	4	70	43093	Bracket—Receptacle	1
31	456	Nut—Brush Rack Mounting (#10-24)	4	71	4516	Lockwasher 1/4" Ext.	2
32	24849	Pole Shoe Retainer	2	72	638	Hex Nut 1/4-20	2
33	10846	Machine Screw—Brush Holders (#8-32x1 1/2")	2	73	21318	Machine Screw 1/4-20-3/8	2
34	6402	Machine Screw—Capacitor (8-32x3/8")	1	74	48959	Rear Cover	1
35	41744	Brush Rack & D.C. Brush Holder	1	75	48188	Bracket—Electro Magnet	1
36	41393	D.C. Brush	2	76	43291	Generator Support Bracket	1
37	9416	Pole Shoe Screw (Hex 5/16-18x1 3/4")	4	77	467	Cap Screw 5/16-18x3/4	2
38	4637	Screw—D.C. Brush (#10-24x3/8")	4	78	480	Lockwasher 5/16	2
39	44361	Field Coil	1	79	453	Hex Nut 5/16-18	8
40	40758	Allen Screw	4	80	480	Lockwasher 5/16	8
				81	23623	Rubber Shock Mounting (With Cradle)	4
				82	23770	Rubber Foot (Without Cradle)	4
				83	480	Lockwasher 5/16	4
				84	446	Hex Nut 5/16-24	4
				85	48447	Head Bolt	1
				86	48714	Spacer	1
				87	441	Cap Screw (5/16-18x2")	1
				88	456	Hex Nut (5/16-18)	2

Any parts required for gas engine portion of the unit should be obtained from the local engine manufacturer's service station.